

CRL ALUMINUM DOOR MOUNTED STANDARD PULL HANDLES

CRL 1" DIAMETER PUSH AND OFFSET PULL HANDLE SET FOR 36" DOOR

CAT. NO.
M10X3328
M10X3310B
M10X3332D

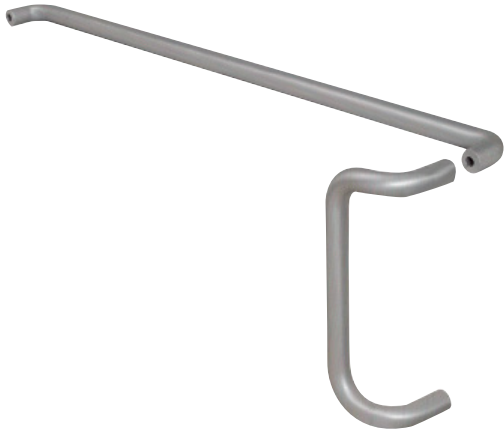

INCLUDED MOUNTING HARDWARE

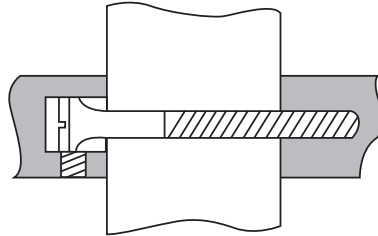

5/16"-18 Threaded Shoulder Bolts
for Back-to-Back Mounting
Included

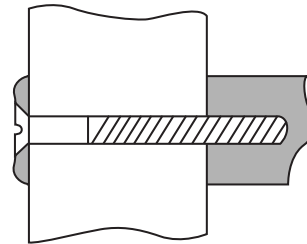

5/16"-20 thru-bolts
with finish washers
Included

MOUNTING TEMPLATE

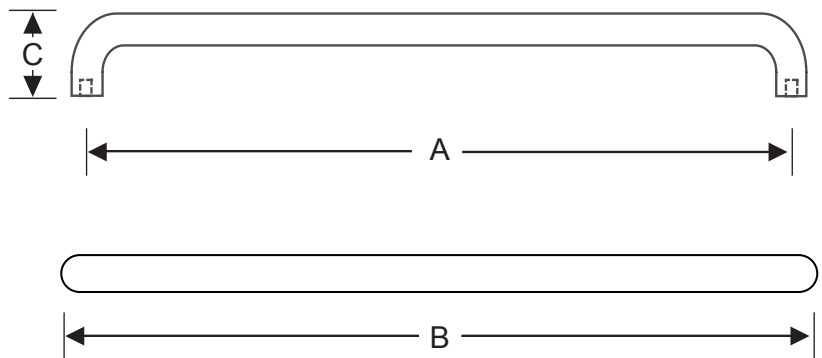
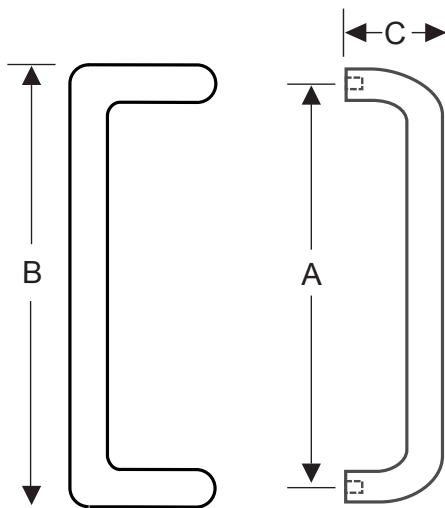

A	B	C
10" x 33" (254 x 838 mm)	11" x 34" (279 x 864 mm)	2-1/4" (57 mm)

Mounting Options	Wood/Aluminum up to 1-3/4" (45 mm)	Wood/Aluminum Hole Size
Mounting Hardware	Included	5/16" (8 mm)

NOTE: Optional hardware kits must be purchased separately.

