

F144 – SK25
CRL Ludwig 3/8" Standard Fit
Screen and Storm Window Snap Fasteners

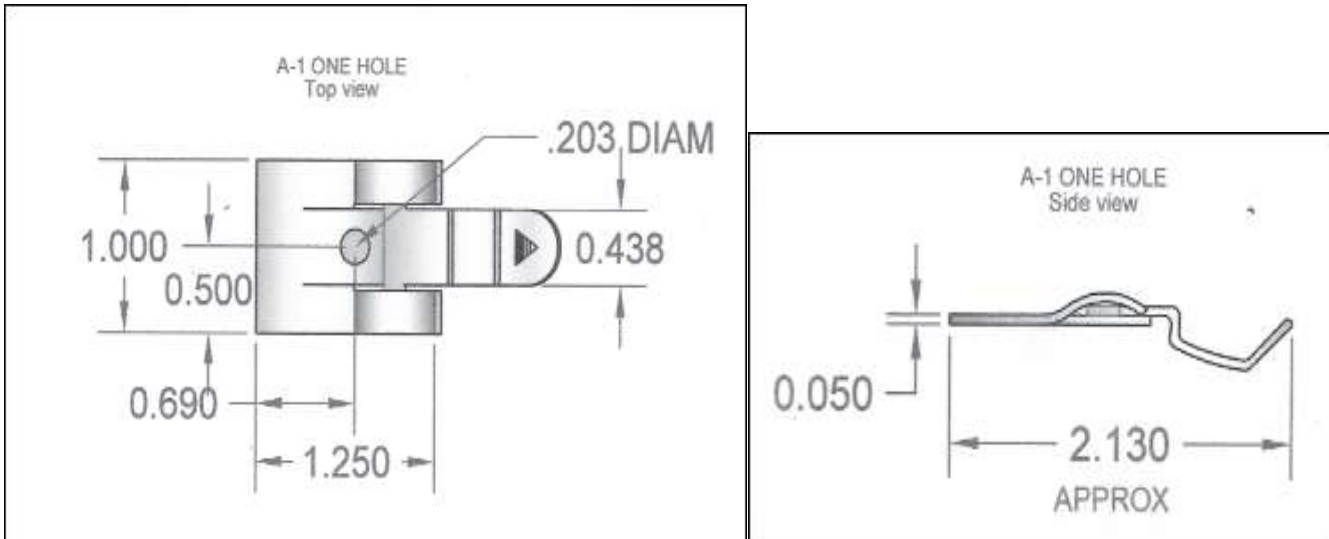

- Made of hardened spring steel plated to resist rust and corrosion, these fasteners use spring tension to hold screens or storm windows firmly in place.
- They stop window rattling because they hold tight and help save energy by keeping storm windows held snugly in place, reducing heat loss.
- Two types are available;
- **Standard Ludwig Fasteners** are made to hold wood framed screens and storm windows;
- **Deep fit Ludwig Fasteners** are designed to compensate for the difference in the thickness of wood window frames and thin aluminum screen or storm window frames.