

CRL ALUMINUM DOOR MOUNTED STANDARD PULL HANDLES

CRL GLASS MOUNTED CRESCENT MID-MOUNT BACK-TO-BACK PULL HANDLE



CAT. NO.
CH12X12
CH18X18
CH24X24

INCLUDED MOUNTING HARDWARE

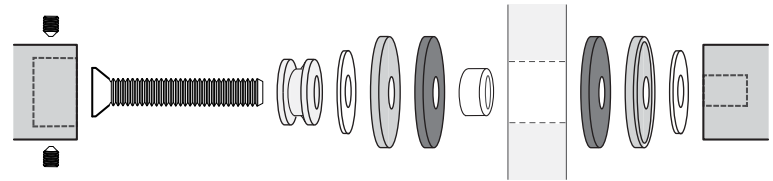

5/16" -18 Back-to-Back
Glass Door Mount Shown

MOUNTING TEMPLATE

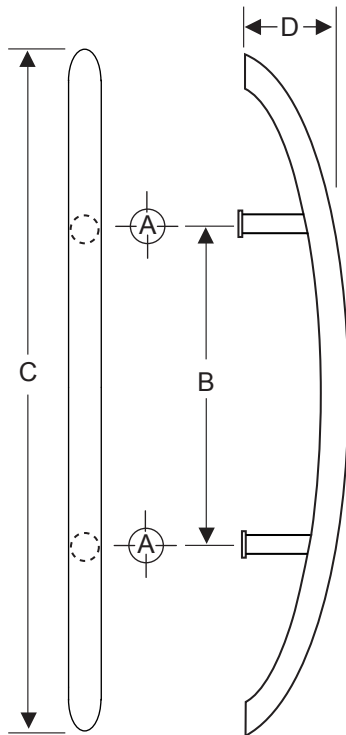

ADD TO CAT. NO. FOR FINISH

BS = BRUSHED STAINLESS

PS = POLISHED STAINLESS

CAT. NO.	B	C	D
CH12X12	6" (152 mm)	12" (305 mm)	3-3/4" (95.3 mm)
CH18X18	9" (229 mm)	18" (457 mm)	3-3/4" (95.3 mm)
CH24X24	12" (305 mm)	24" (610 mm)	3-3/4" (95 mm)

Mounting Options	Glass 3/8"-3/4" (10 to 19 mm)	Wood/Aluminum up to 1-3/4" (45 mm)
Hole Size: A	5/8" (16 mm)	5/16" (8 mm)
Hardware	Cat. No. F40WK Included	Cat. No. TB4CH Optional

NOTE: Optional hardware kits must be purchased separately.

