

# CRL ALUMINUM DOOR MOUNTED STANDARD PULL HANDLES

## CRL 10" X 28" BACK-TO-BACK OFFSET COMBINATION PUSH AND PULL HANDLE SET

CAT. NO.  
CD10X28



### INCLUDED MOUNTING HARDWARE

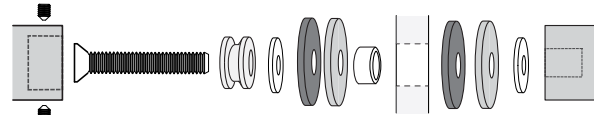

5/16"-18 Back-to-Back  
Glass Door Mount Shown

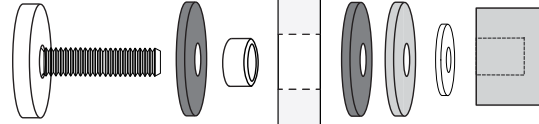

5/16"-18 Finish Cap  
Mount Shown

## MOUNTING TEMPLATE

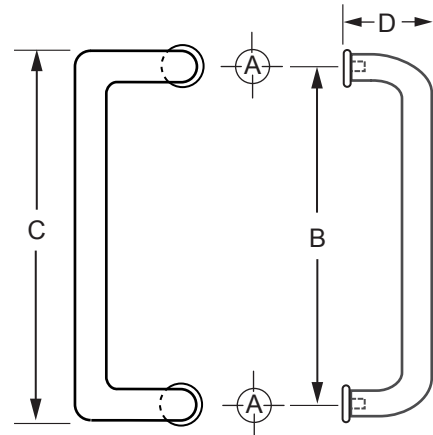
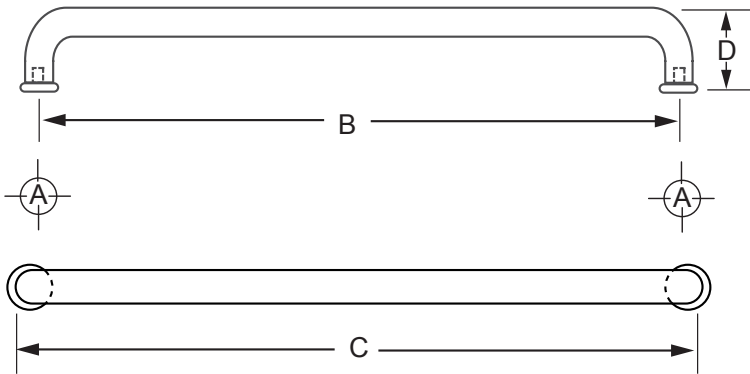

Hole Size: A	B	C	D
Glass 5/8" (16 mm)	28" (711 mm)	29" (736.6 mm)	3" (76 mm)

B	C	D
10" (254 mm)	11" (279 mm)	3" (76 mm)

ADD TO CAT. NO. FOR FINISH
BR = POLISHED BRASS
BS = BRUSHED STAINLESS
PS = POLISHED STAINLESS
SA = SATIN ANODIZED
DU = DARK BRONZE

Mounting Options	Glass 3/8"-3/4" (10-19 mm)	Wood/Aluminum up to 1-3/4" (45 mm)
Mounting Hardware	2 ea. Cat. No. F40SK 1 ea. Cat. No. F40WK Included	1 ea. Cat. No. TB4CH 2 ea. Cat. No. F41WK Included

**NOTE:** Optional hardware kits must be purchased separately.

