

CRL ALUMINUM DOOR MOUNTED STANDARD PULL HANDLES

CRL VARIANT ADJUSTABLE PULL HANDLE WITH VP1 MOUNTING POST



CAT. NO.
VPS116
VPS122
VPS128

INCLUDED MOUNTING HARDWARE

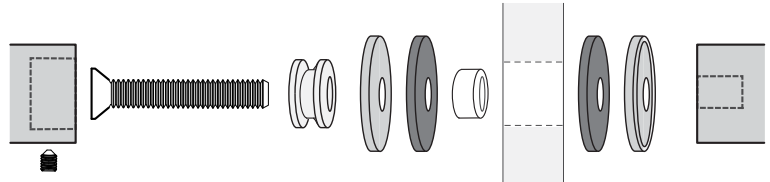

5/16"-18 Back-to-Back
Glass Door Mount Shown

MOUNTING TEMPLATE

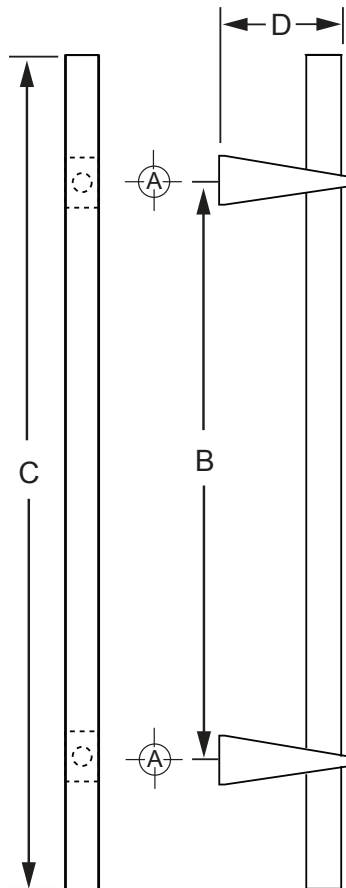

ADD TO CAT. NO. FOR FINISH

BS = BRUSHED STAINLESS

PS = POLISHED STAINLESS

CAT. NO.	Hole Size: A		B	C	D
	Glass	Wood/ Aluminum			
VPS116	5/8" (16 mm)	5/16" (8 mm)	12" (304.8 mm)	16" (406 mm)	2-3/4" (70 mm)
VPS122	5/8" (16 mm)	5/16" (8 mm)	18" (457 mm)	22" (558.8 mm)	2-3/4" (70 mm)
VPS128	5/8" (16 mm)	5/16" (8 mm)	24" (610 mm)	28" (711 mm)	2-3/4" (70 mm)

Mounting Options	Glass 3/8"-3/4" (10 to 19 mm)	Wood/Aluminum up to 1-3/4" (45 mm)
Mounting Hardware	Cat. No. F40WK Included	Cat. No. TB4CH

NOTE: Optional hardware kits must be purchased separately.

