

OPTIONAL DWKEYLOCK INSTALLATION

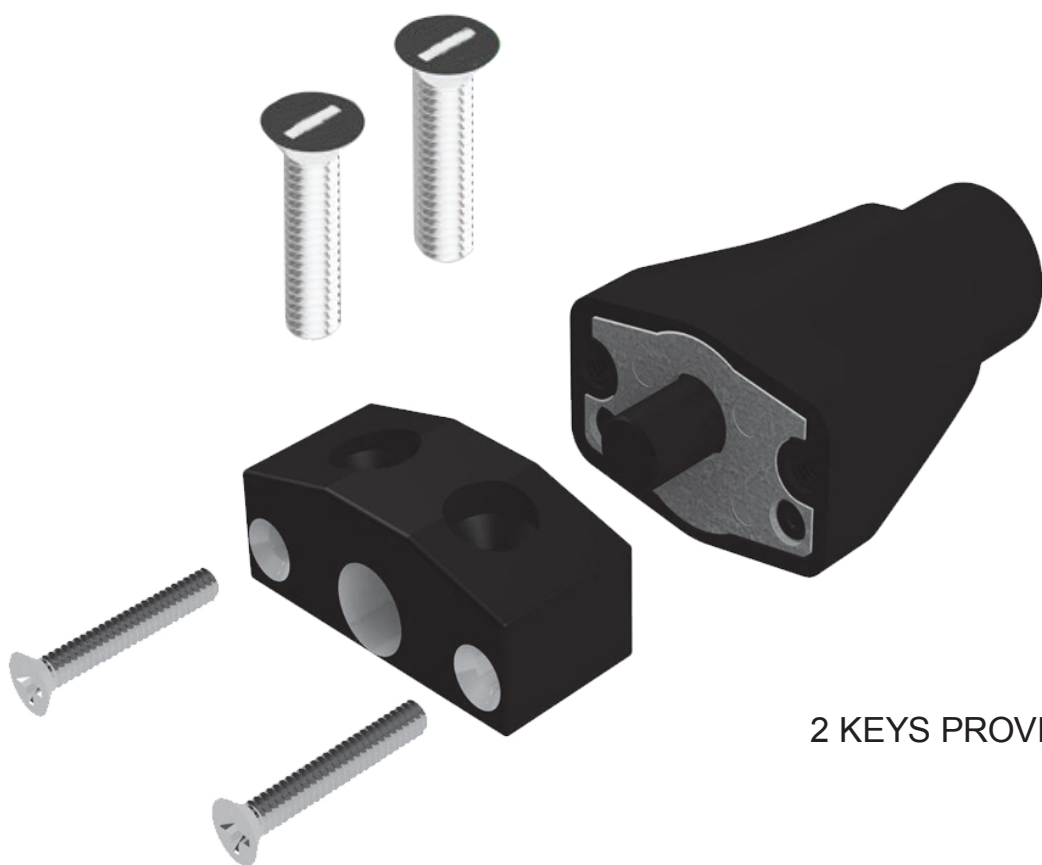

2 KEYS PROVIDED

ACCESSORY FOR CRL "DW" SERIES DELUXE SLIDING SERVICE WINDOWS
FOR OX, XO,OXO,XOX CONFIGURATIONS,
(NOT FOR XX CONFIGURATIONS)

INSTALLATION ON DW WINDOW ALUMINUM TRACK

NOTE: CRL Cat. No. DWKEYLOCK, sold separately, includes the plunger lock, adaptor block and screws.

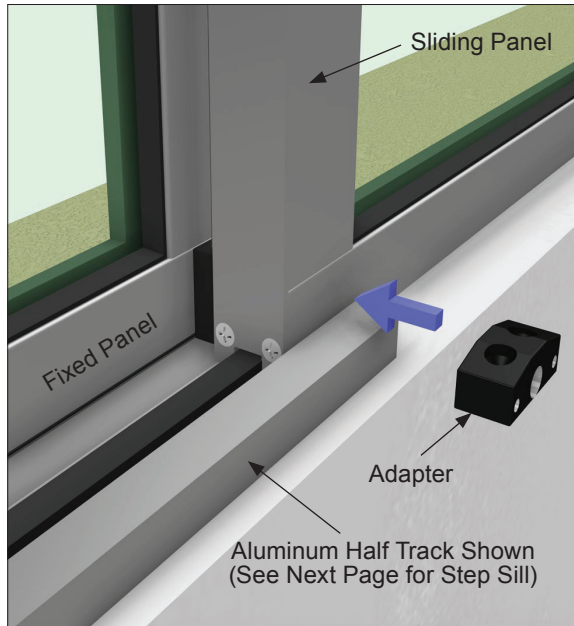

1. Position the Adapter on the track and align with the end of the Sliding Panel.

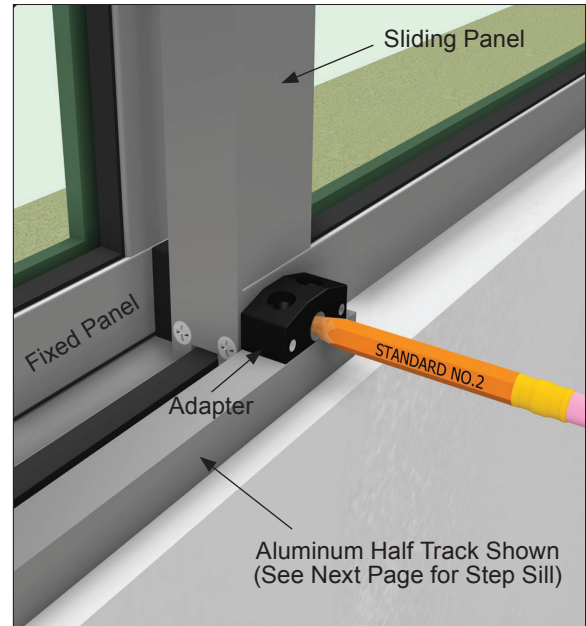

2. Transfer the clearance hole for the Keyed Lock Pin onto the Sliding Door.

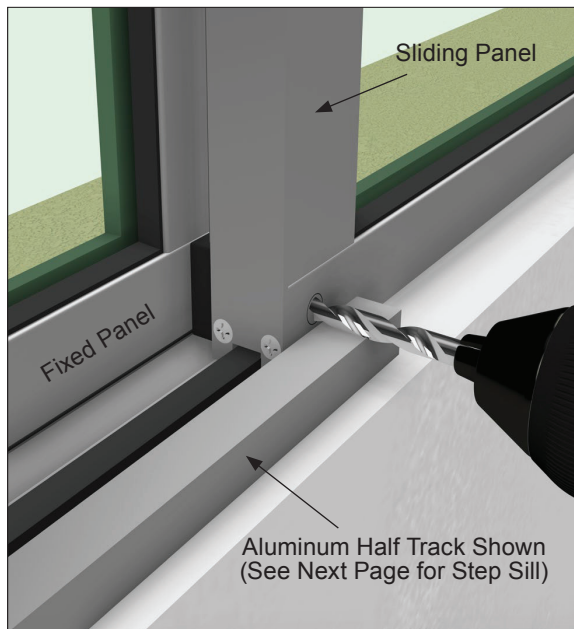

3. Drill a strike hole 3/4" deep with 3/8" Diameter drill bit.

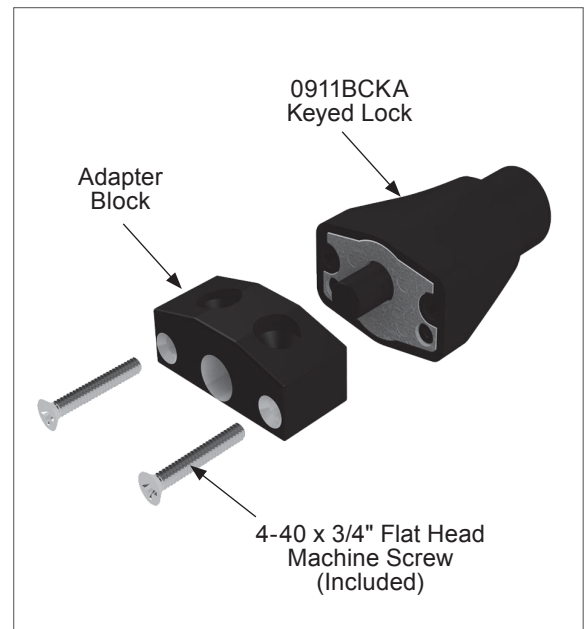

4. Attach Adapter to Keyed Lock using two 4-40 x 3/4" Flat Head Machine Screws (Included).

INSTALLATION ON DW ALUMINUM TRACK (CONTINUED)

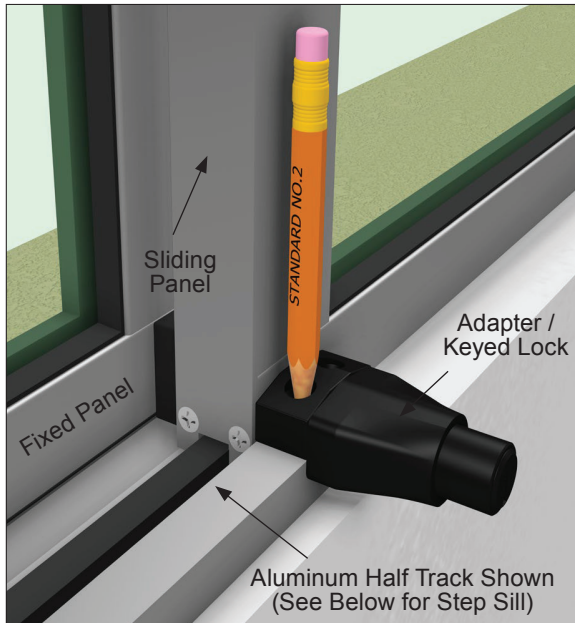

5. Position Adapter / Keyed Lock on the track. Ensure the plunger enters the strike hole cleanly, align with the end of the Sliding Panel. Transfer the Adapter attachment holes onto the sill. Drill and tap for an 8-32 screw.

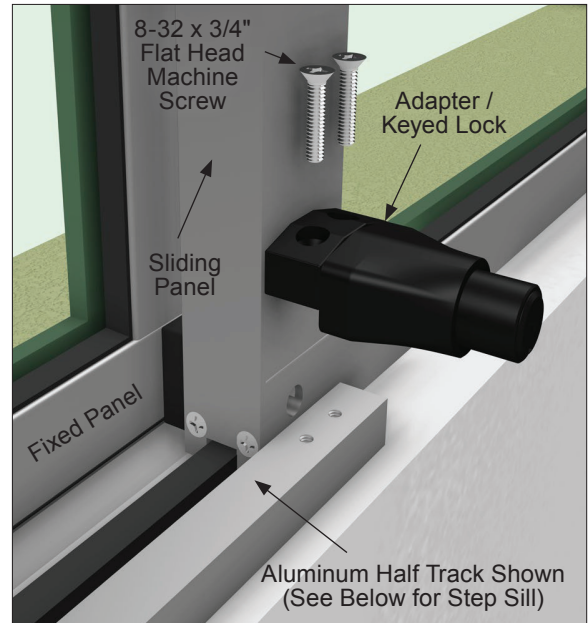

6. Attach the Adapter / Keyed Lock to the track or sill using two 8-32 x 3/4 Flat Head Machine Screws (Included).

INSTALLATION ON DW WINDOW STAINLESS STEEL SILL

Follow Steps 1-6 for installation. **NOTE:** The Step Sill shown below is higher than the Aluminum Track.

