



Reliance™-TC LT Curtain Wall

Limitless performance. Uncompromised design.

Great design demands great performance - now you can have both without compromise. The Reliance™-TC LT sets a new standard for curtain wall innovation, offering the flexibility to **choose advanced performance with a 1" IGU or next-generation efficiency with a 1" thin triple IGU**. Achieving **U-factors as low as 0.18**, it pushes the limits of thermal performance while **meeting IECC Climate Zones 4 - 8 and evolving stretch code requirements**. With its **slim 2" sightline, seismic resilience, and Red List Free option**, Reliance™-TC LT pushes efficiency further, without ever compromising the elegance of design.

Reliance™-TC LT Curtain Wall

Details

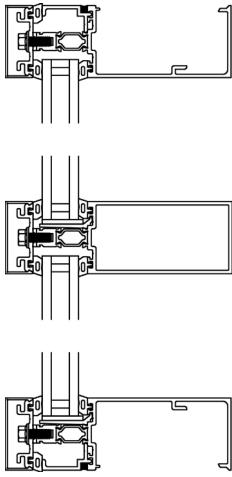

Double Pane Glazing

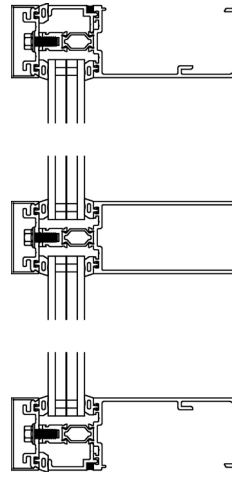
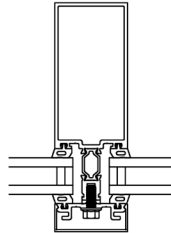
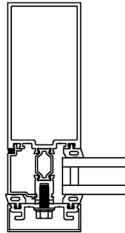

Thin Triple Pane Glazing

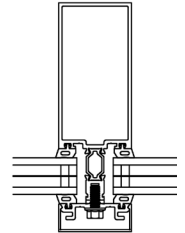
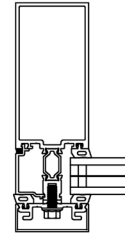

Features

- 2" sightline
- 6-1/4" and 7-1/2" depth for double pane 1" infill
- 1" IG infill standard with 1/4" spandrel glazing adapters
- Accepts 1" thin triple insulating glass unit
- Polyamide and aluminum pressure plate options
- Front set, outside glazed configuration
- Dry glazed
- Zone glazed
- Shear block assembly
- Field glazed
- Captured and SSG vertical mullions
- Twin span with splice sleeve
- Low profile corner mullions
- Integrated Solar Eclipse™ sunshade
- Accommodates Zero Sightline projected and casement vents

Performance

Thermal Performance per NFRC 100 when using 1" CoG insulating glass of 0.24:
U-factor: 0.29

Thermal Performance per NFRC 100 when using 1" thin triple CoG insulating glass of 0.10: U-factor: 0.18

CRF: Frame: 80 / Glass: 72

Air Infiltration: <0.06 CFM/SQ FT (6.24PSF) per ASTM E283

Static Water: 20 PSF per ASTM E331

Dynamic Water: 20 PSF per AAMA 501.1

Cyclic Water: 20 PSF per ASTM E547

Severe Wind-Driven Rain: Level 10 per AAMA 520

Seismic per AAMA 501.4 and AAMA 501.6

STC per ASTM E90: 30 with standard 1" IGU; 38 with laminated 1" IGU

OITC per ASTM E90: 25 with standard 1" IGU; 31 with laminated 1" IGU

NFRC Certified Products Directory and CMAST

Red List Free

Finishes

- Factory painted KYNAR 500/ HYLAR 5000 finishes, meeting all provisions of AAMA 2605
- Factory-anodized finishing
- Dual finish capability

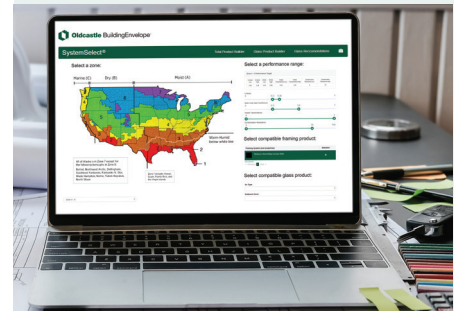

Simplify your search with SystemSelect™

Compare thermal and visual performance details for entire architectural glass and metal systems quickly with our free online tool.

www.systemselect.obe.com

For more info: Contact your Oldcastle BuildingEnvelope® representative, visit us online at OBE.com, or call us at 1-866-OLDCASTLE (653-2278).

