

USE OF GASKETS
 FOR 1/4" (6mm) GLASS: USE ONE THICK GASKET ON EACH SIDE
 FOR 5/16" (8mm) GLASS: USE ONE THIN GASKET ON EACH SIDE

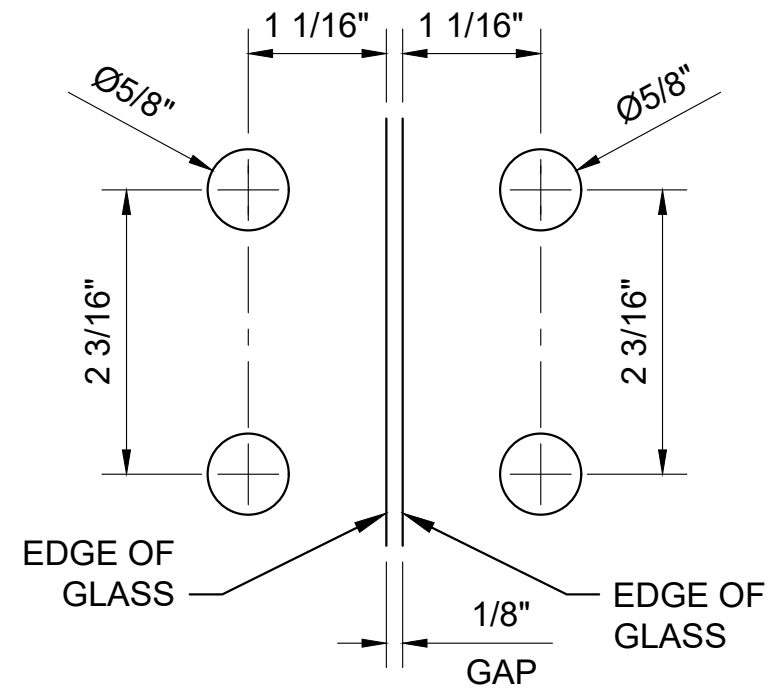

GLASS FABRICATION TEMPLATE

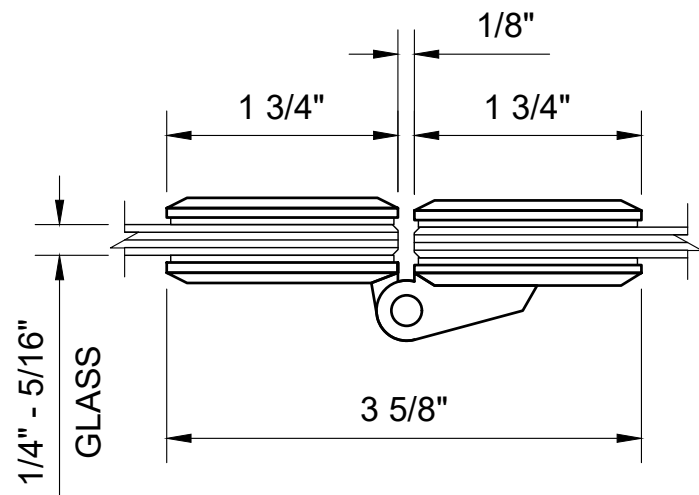
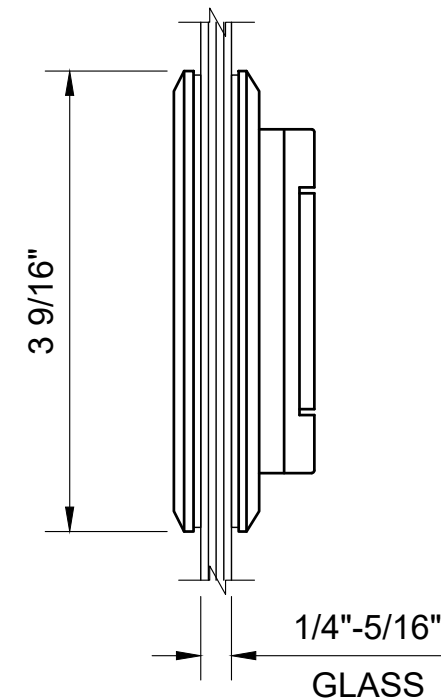
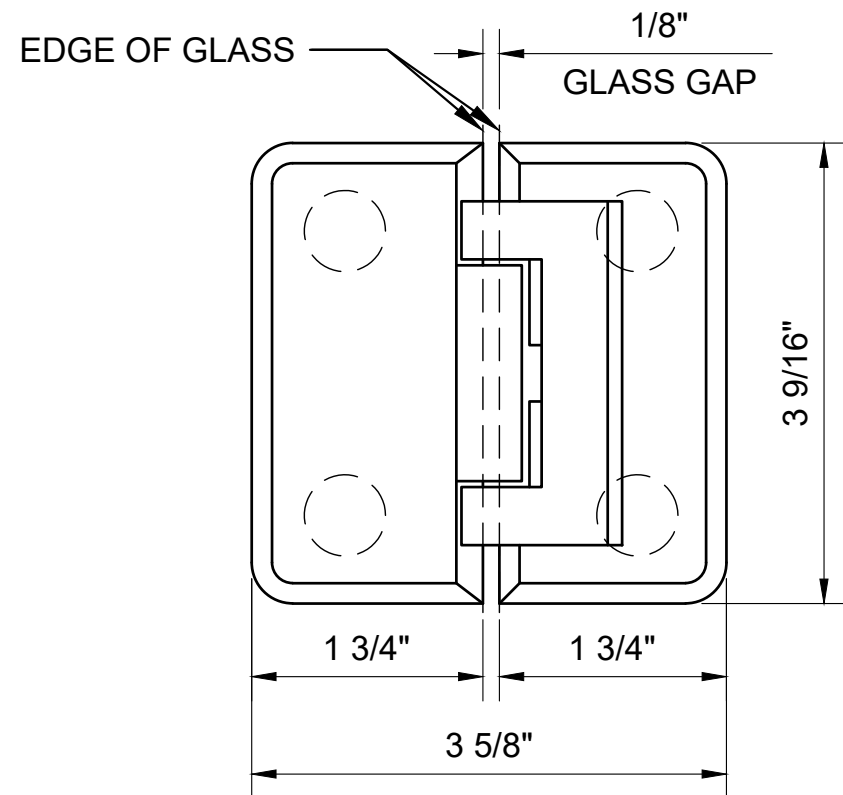

CATALOG NUMBER	FINISH
PET181CH	POLISHED CHROME
PET181BR	POLISHED BRASS
PET181BN	BRUSHED NICKEL
PET181GP	GOLD PLATE
PET181PN	POLISHED NICKEL
PET181SC	SATIN CHROME

PET181XX - CRL PETITE SERIES 180° OUT SWING ONLY GLASS TO GLASS HINGE

DATE: 3/8/19
 SCALE: 6"=1'-0"
 DRAWN BY: VM

DESCRIPTION: CRL PETITE SERIES HINGE
 CTS
 PET181 180° SWING OUT ONLY
 GLASS TO GLASS HINGE
 www.crlaurence.com

C.R. LAURENCE CO. ARCHITECTURAL PRODUCTS
 2503 E. Vernon Avenue, Los Angeles, C.A 90058-1897
 PH (800)-421-6144 FX: 800-587-7501 www.crlaurence.com

