

CRL ALUMINUM DOOR MOUNTED STANDARD PULL HANDLES

CRL 10" X 33" BACK-TO-BACK OFFSET COMBINATION PUSH AND PULL HANDLE SET

CAT. NO.
CD10X33



INCLUDED MOUNTING HARDWARE

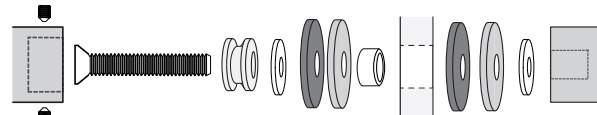

5/16"-18 Back-to-Back
Glass Door Mount Shown

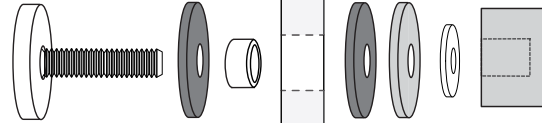

5/16"-18 Finish Cap
Mount Shown

MOUNTING TEMPLATE

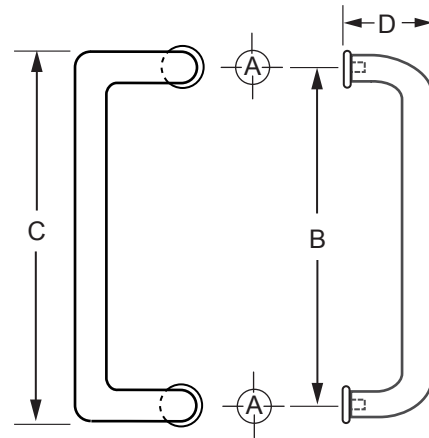
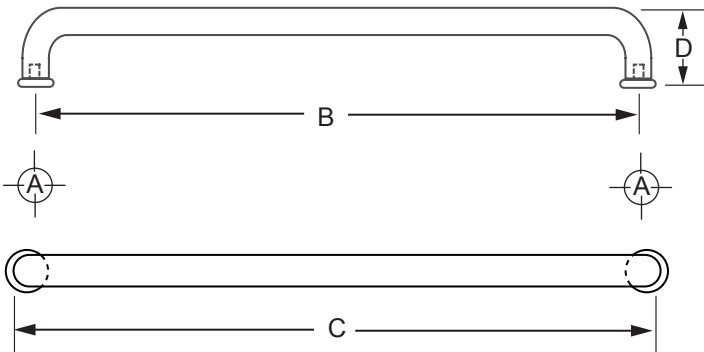

| Hole Size: A | B | C | D |
|--------------------------|-----------------|-----------------|---------------|
| Glass 5/8" (16 mm) | 33" (838 mm) | 34" (864 mm) | 3" (76 mm) |

| B | C | D |
|-----------------|-----------------|---------------|
| 10" (254 mm) | 11" (279 mm) | 3" (76 mm) |

| ADD TO CAT. NO. FOR FINISH |
|----------------------------|
| BR = POLISHED BRASS |
| BS = BRUSHED STAINLESS |
| PS = POLISHED STAINLESS |
| SA = SATIN ANODIZED |
| DU = DARK BRONZE |

| Mounting Options | Glass 3/8"-3/4" (10-19 mm) | Wood/Aluminum up to 1-3/4" (45 mm) |
|-------------------|--|--|
| Mounting Hardware | 2 ea. Cat. No. F40SK 1 ea. Cat. No. F40WK Included | 1 ea. Cat. No. TB4CH 2 ea. Cat. No. F41WK Included |

NOTE: Optional hardware kits must be purchased separately.

