

CRL ALUMINUM DOOR MOUNTED STANDARD PULL HANDLES

CRL 24-1/2" OVERALL LENGTH GLASS MOUNTED LADDER STYLE PULL HANDLE WITH ACRYLIC SEMI-INSERTS



CAT. NO.
CA18X18

INCLUDED MOUNTING HARDWARE

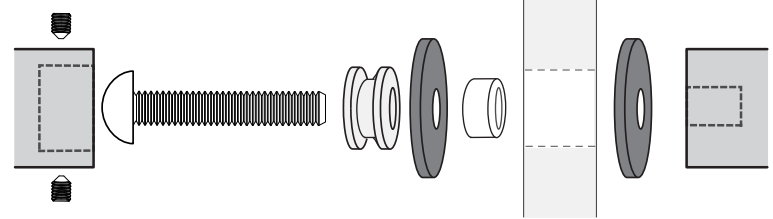

M8-1.25 Back-to-Back
Glass Door Mount Shown

MOUNTING TEMPLATE

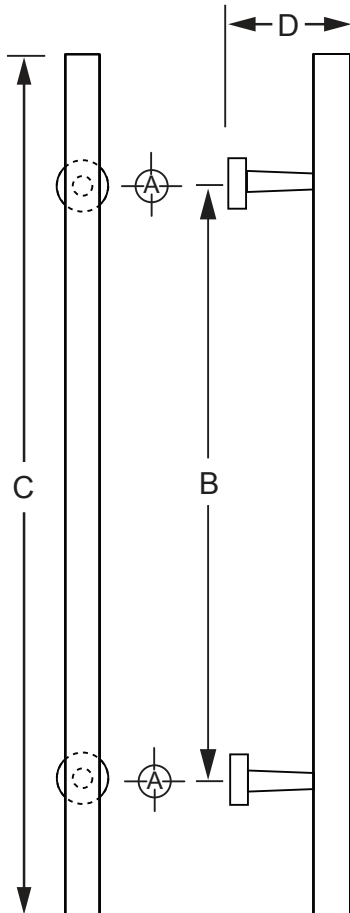

ADD TO CAT. NO. FOR FINISH

BR = POLISHED BRASS

PS = POLISHED STAINLESS

Hole Size: A		B	C	D
Glass 5/8" (16 mm)	Wood/Aluminum 5/16" (8 mm)	18" (457 mm)	24-1/2" (622 mm)	2-11/16" (58.7 mm)

Mounting Options	Glass 3/8"-3/4" (10-19 mm)	Wood/Aluminum up to 1-3/4" (45 mm)
Mounting Hardware	Included	Included

NOTE: Optional hardware kits must be purchased separately.

