

3/4" (19mm) Diameter Brass Tubing
Glass Thickness Range: 1/4" to 1/2" (6 to 12 mm)
Hole Diameter Required: 1/2" (12 mm) (2)

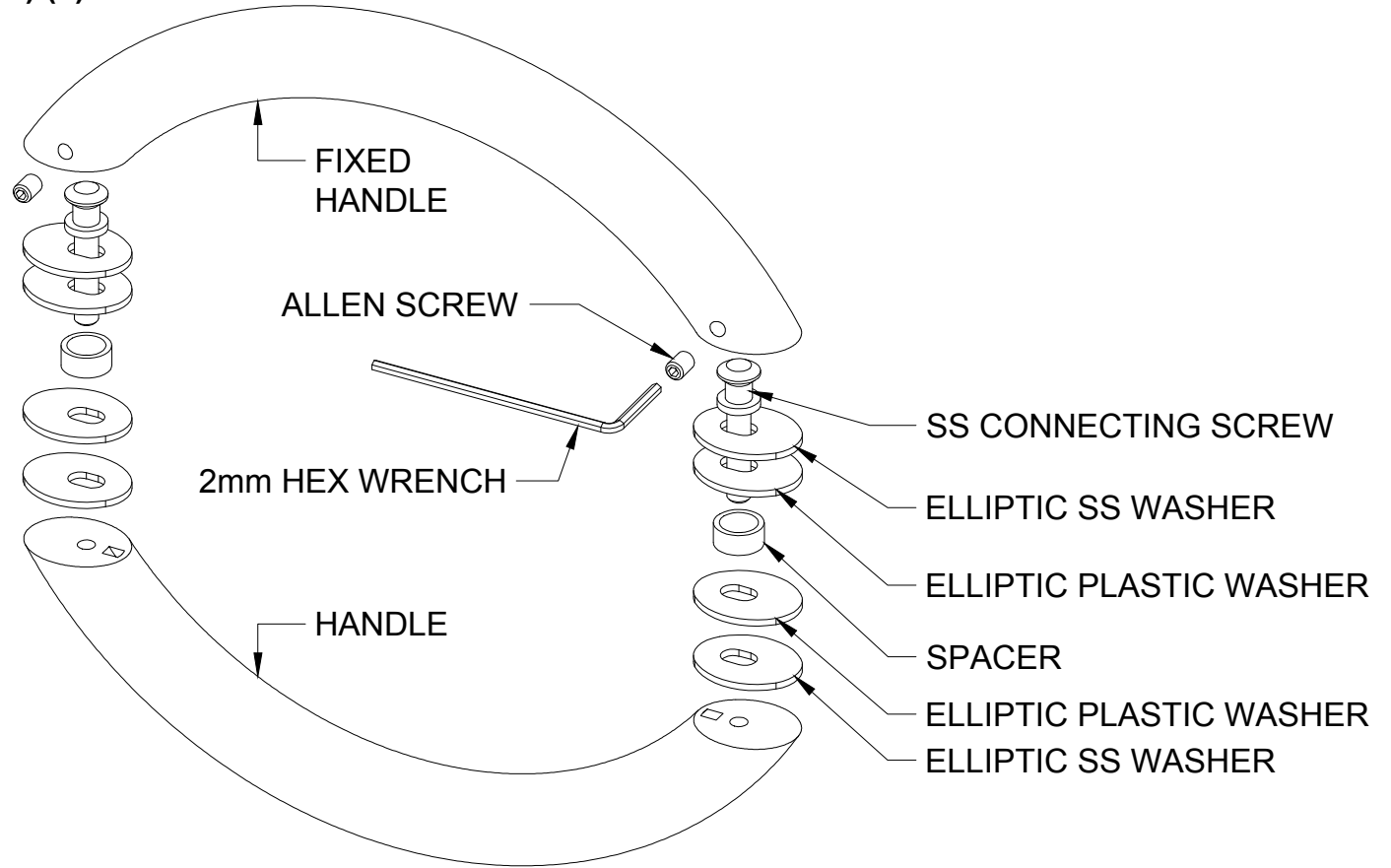

PART NUMBER	FINISH	L
CSH6X6CH	POLISHED CHROME	6"
CSH6X6BR	POLISHED BRASS	6"
CSH6X60RB	OIL RUBBED BRONZE	6"
CSH6X6ABN	ANTIQUÉ BRUSHED NICKEL	6"
CSH6X6ABR	ANTIQUÉ BRUSHED BRASS	6"
CSH6X6BN	BRUSHED NICKEL	6"
CSH6X6BSC	BRUSHED SATIN CHROME	6"
CSH6X6PN	POLISHED NICKEL	6"
CSH6X6SB	SATIN BRASS	6"
CSH6X6SC	SATIN CHROME	6"
CSH6X6W	WHITE	6"

CSH8X8CH	POLISHED CHROME	8"
CSH8X8BR	POLISHED BRASS	8"
CSH8X80RB	OIL RUBBED BRONZE	8"
CSH8X8ABN	ANTIQUÉ BRUSHED NICKEL	8"
CSH8X8BN	BRUSHED NICKEL	8"
CSH8X8BSC	BRUSHED SATIN CHROME	8"
CSH8X8PN	POLISHED NICKEL	8"
CSH8X8SB	SATIN BRASS	8"
CSH8X8SC	SATIN CHROME	8"
CSH8X8SN	SATIN NICKEL	8"
CSH8X8W	WHITE	8"



C.R. LAURENCE CO.
 ARCHITECTURAL PRODUCTS
 PH (800)-421-6144 FX: 800-587-7501
 www.crlaurence.com

DESCRIPTION:

CRESENT STYLE BACK TO BACK PULL HANDLES

PART #:	SEE CHART	DATE:	10/29/2018
FILE NAME:	CSH_	SCALE:	NTS
DRAWN BY:	VM		