

CRL ALUMINUM DOOR MOUNTED STANDARD PULL HANDLES

CRL GLASS MOUNTED CURVED TUBULAR BACK-TO-BACK PULL HANDLE



CAT. NO.
RC12X12
RC18X18
RC24X24

INCLUDED MOUNTING HARDWARE

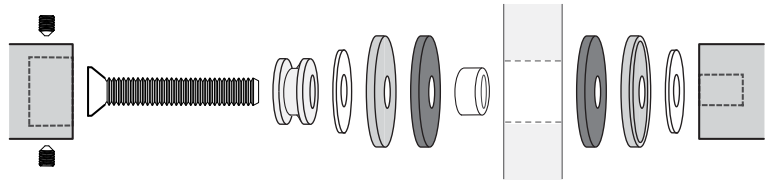

5/16"-18 Back-to-Back
Glass Door Mount Shown

MOUNTING TEMPLATE

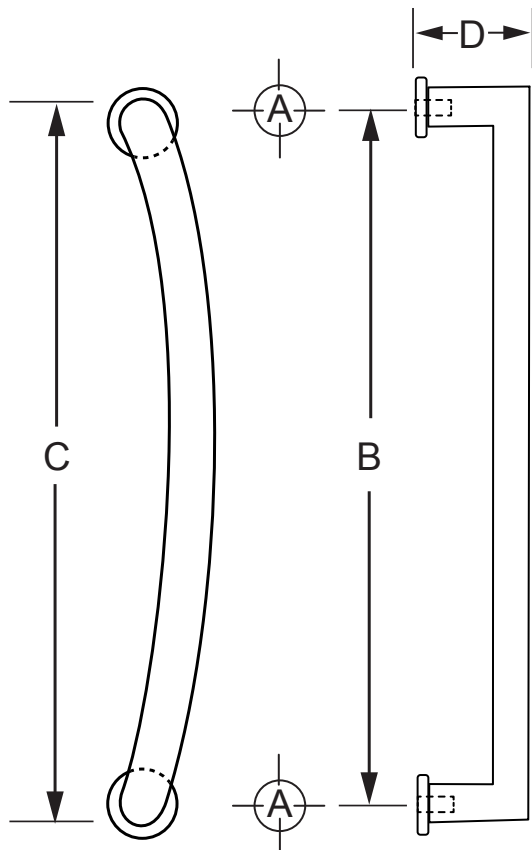

ADD TO CAT. NO. FOR FINISH

BS = BRUSHED STAINLESS

PS = POLISHED STAINLESS

CAT. NO.	Hole Size: A	B	C	D
	Glass			
RC12X12	5/8" (16 mm)	12" (304.8 mm)	13" (330 mm)	3" (76.2 mm)
RC18X18	5/8" (16 mm)	18" (457 mm)	19" (483 mm)	3" (76.2 mm)
RC24X24	5/8" (16 mm)	24" (610 mm)	25" (635 mm)	3" (76.2 mm)

Mounting Options	Glass 3/8"-3/4" (10 to 19 mm)	Wood/Aluminum up to 1-3/4" (45 mm)
Mounting Hardware	Cat. No. F40WK Included	Cat. No. TB4CH

NOTE: Optional hardware kits must be purchased separately.

