

CRL ALUMINUM DOOR MOUNTED STANDARD PULL HANDLES

CRL 17" GLASS MOUNTED BACK-TO-BACK CURVED PULL HANDLE



CAT. NO.
CX17X17

INCLUDED MOUNTING HARDWARE

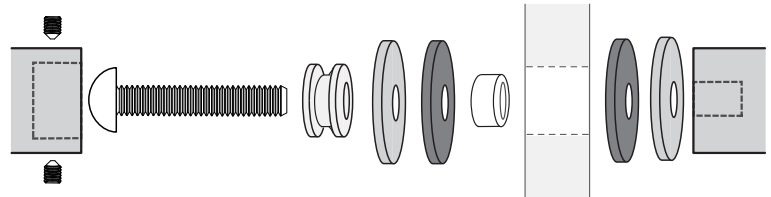

M8-1.25 Back-to-Back
Glass Door Mount Shown

MOUNTING TEMPLATE

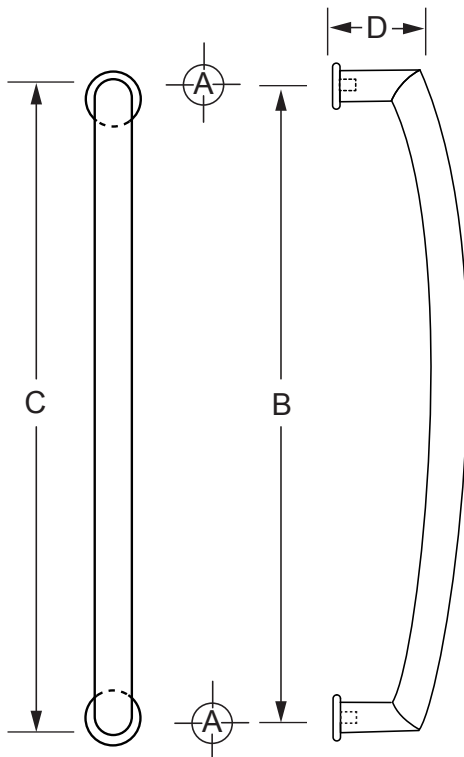

ADD TO CAT. NO. FOR FINISH
BS = BRUSHED STAINLESS
PS = POLISHED STAINLESS

Hole Size: A		B	C	D
Glass 5/8" (16 mm)	Wood/Aluminum 5/16" (8 mm)	16-3/4" (425 mm)	17-3/4" (451 mm)	3-15/16" (100 mm)

Mounting Options	Glass 3/8"-3/4" (10-19 mm)	Wood/Aluminum up to 1-3/4" (45 mm)
Mounting Hardware	Included	Included

NOTE: Optional hardware kits must be purchased separately.

