

USE OF GASKETS

FOR 5/16" (18mm) GLASS: USE ONE THICK GASKET ON EACH SIDE
 FOR 3/8" (10mm) GLASS: USE ONE THIN GASKET ON EACH SIDE

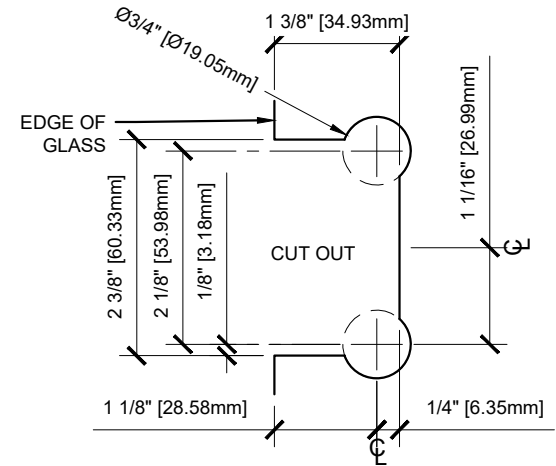

GLASS FABRICATION TEMPLATE

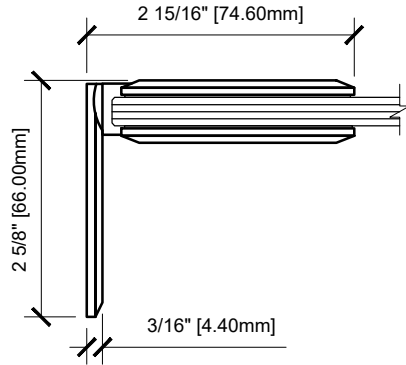
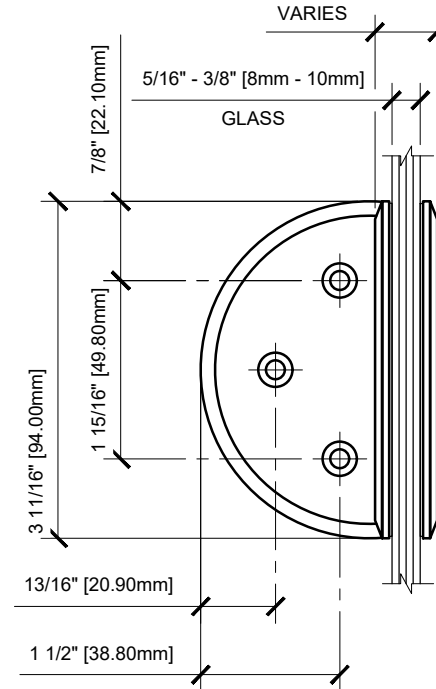
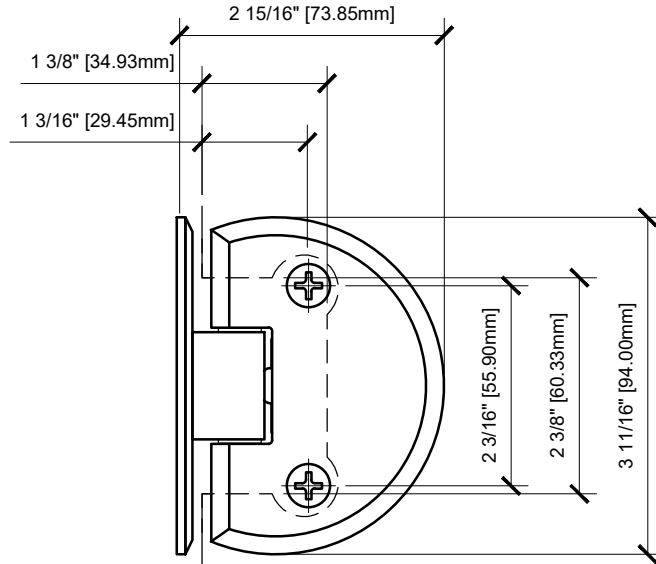

CATALOG NUMBER	FINISH
CLA044CH	POLISHED CHROME
CLA044BR	BRASS
CLA044BL	BLACK
CLA044BN	BRUSHED NICKEL
CLA044GP	GOLD PLATED
CLA044PN	POLISHED NICKEL
CLA044SB	SATIN BRASS
CLA044W	WHITE

CLA044XX - CRL CLASSIQUE SERIES WALL MOUNT FLUSH BACK PLATE HINGE

DATE: 1/03/19
 SCALE: 6" = 1'-0"
 DRAWN BY: BRIAN R.

DESCRIPTION: CRL CLA044
 CRL CLASSIQUE SERIES
 WALL MOUNT HINGE - FLUSH BACK PLATE

C.R. LAURENCE CO., ARCHITECTURAL PRODUCTS
 2503 E. Vernon Avenue, Los Angeles, C.A 90058-1897
 PH (800)-421-6144 FX: 800-587-7501 www.crlaurence.com

