

ACTUAL SIZE

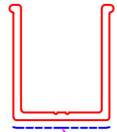

EXPOSED S.

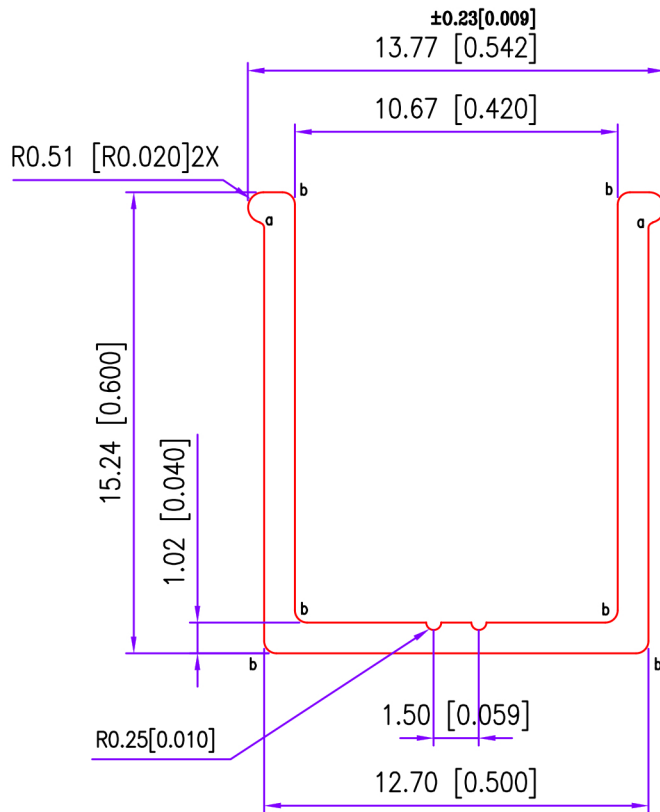

RANGE	TOLERANCE
0 - 3	±0.15
3 - 6	±0.18
6 - 12	±0.20
12 - 19	±0.23
19 - 25	±0.25
25 - 38	±0.30
38 - 50	±0.35
50 - 100	±0.61
100 - 150	±0.86
150 - 200	±1.12

# CRITICAL DIMENSION  
 \* DENOTE IMPORTANT DIMENSION  
 ----- INDICATES EXPOSED SURFACE  
 - - - - - INDICATES PAINT SURFACE  
 DIMENSION ARE MILIMETER AND INCH  
 UNSPEC. CORNERS RADIUS MAX. 0.25[0.000]mm  
 F = FULL RADIUS V = VEE GROOVE 0.00[0.000] X 90.0°  
 a = 0.18[0.007] b = 0.41[0.016] c = 0.00[0.000] d = 0.00[0.000]

UNSPEC WALL THICKNESS *1.02 mm		*0.040 inch	18-05-2021
CIRCUM DIA	: 19.82 mm	0.780 inch	FINISH : -
SECTION AREA	: 42.405 mm <sup>2</sup>	0.066 inch <sup>2</sup>	ALLOY : 6463-T5
LINIER WEIGHT	: 0.115 kg/m	0.077 lb/ft	RATIO : 36
PERIMETER	: 85.002 mm	3.347 inch	MACHINE : 660 4HOLE
EXPOSED SURFACE	: 13.164 mm	0.518 inch	MATING WITH SECTION :
Straightness up to 100 1mm/1m ; over100 1.5mm/1m			Flatness SL 0.10 HL 0.15 mm/25 mm
			Twist 0.5°/300 mm ; 0.8'x total length (m) ; 3' max