

CRL ALUMINUM DOOR MOUNTED STANDARD PULL HANDLES

CRL 18" GLASS MOUNTED ROUND TUBE CURVED SHAPE HANDLE



CAT. NO.
CY18X18

INCLUDED MOUNTING HARDWARE

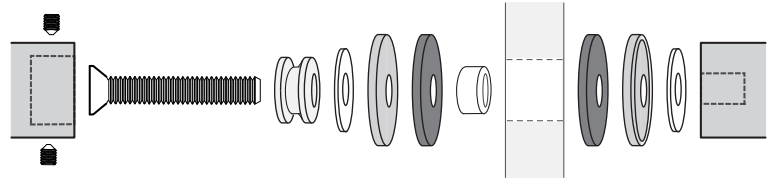

5/16"-18 Back-to-Back
Glass Door Mount Shown

MOUNTING TEMPLATE

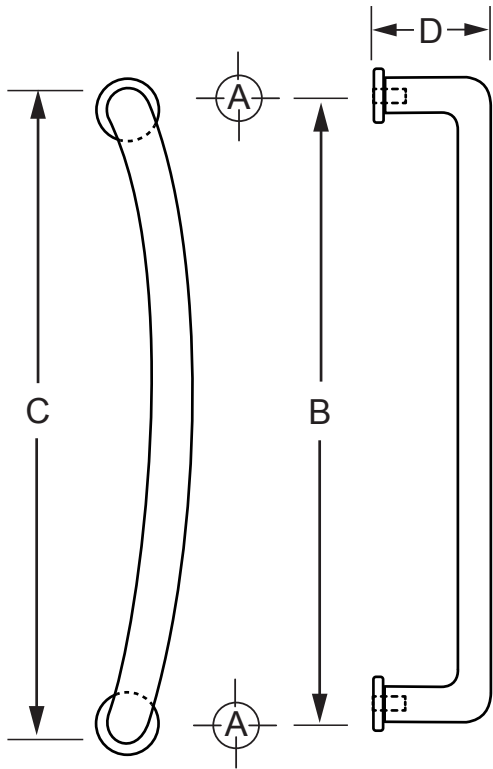

ADD TO CAT. NO. FOR FINISH

BS = BRUSHED STAINLESS

PS = POLISHED STAINLESS

Hole Size: A		B	C	D
Glass 5/8" (16 mm)	Wood/Aluminum 5/16" (8 mm)	18" (457 mm)	19" (483 mm)	3" (76 mm)

Mounting Options	Glass 3/8"-3/4" (10 to 19 mm)	Wood/Aluminum up to 1-3/4" (45 mm)
Mounting Hardware	F40WK Included	Cat. No. TB4CH

NOTE: Optional hardware kits must be purchased separately.

