

GLASS: 5/16" (8mm)
GLASS: 3/8" (10mm)
GLASS: 1/2" (12mm)

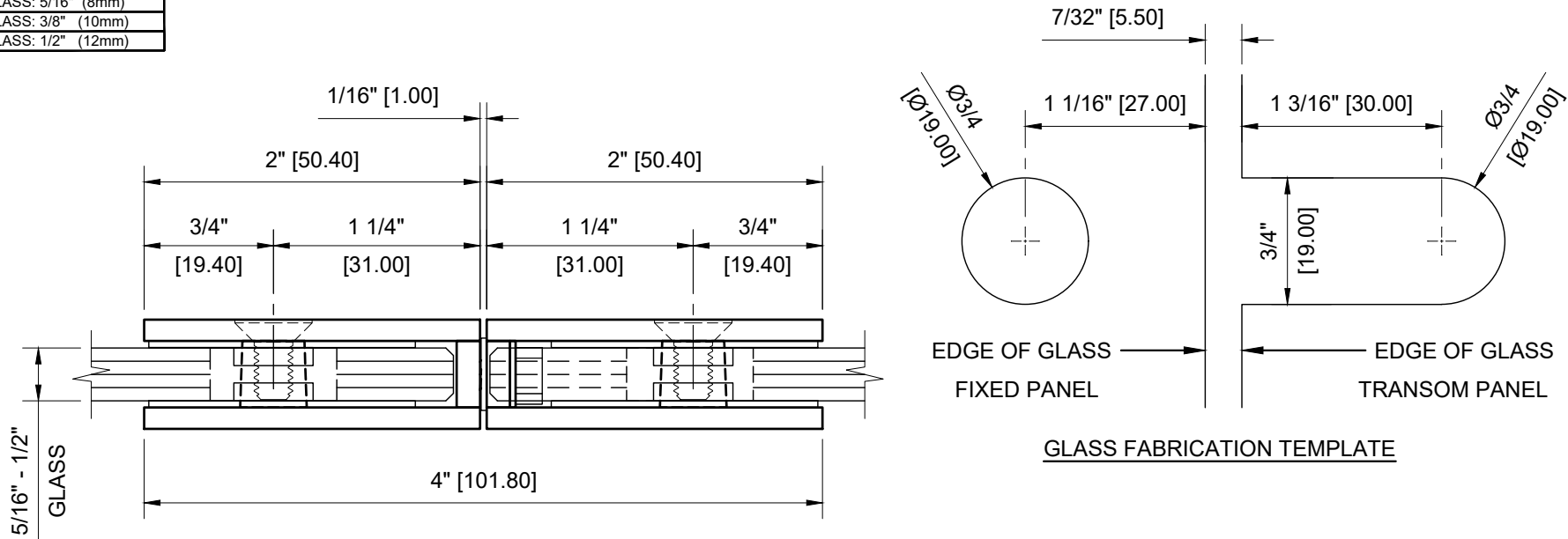

GLASS FABRICATION TEMPLATE

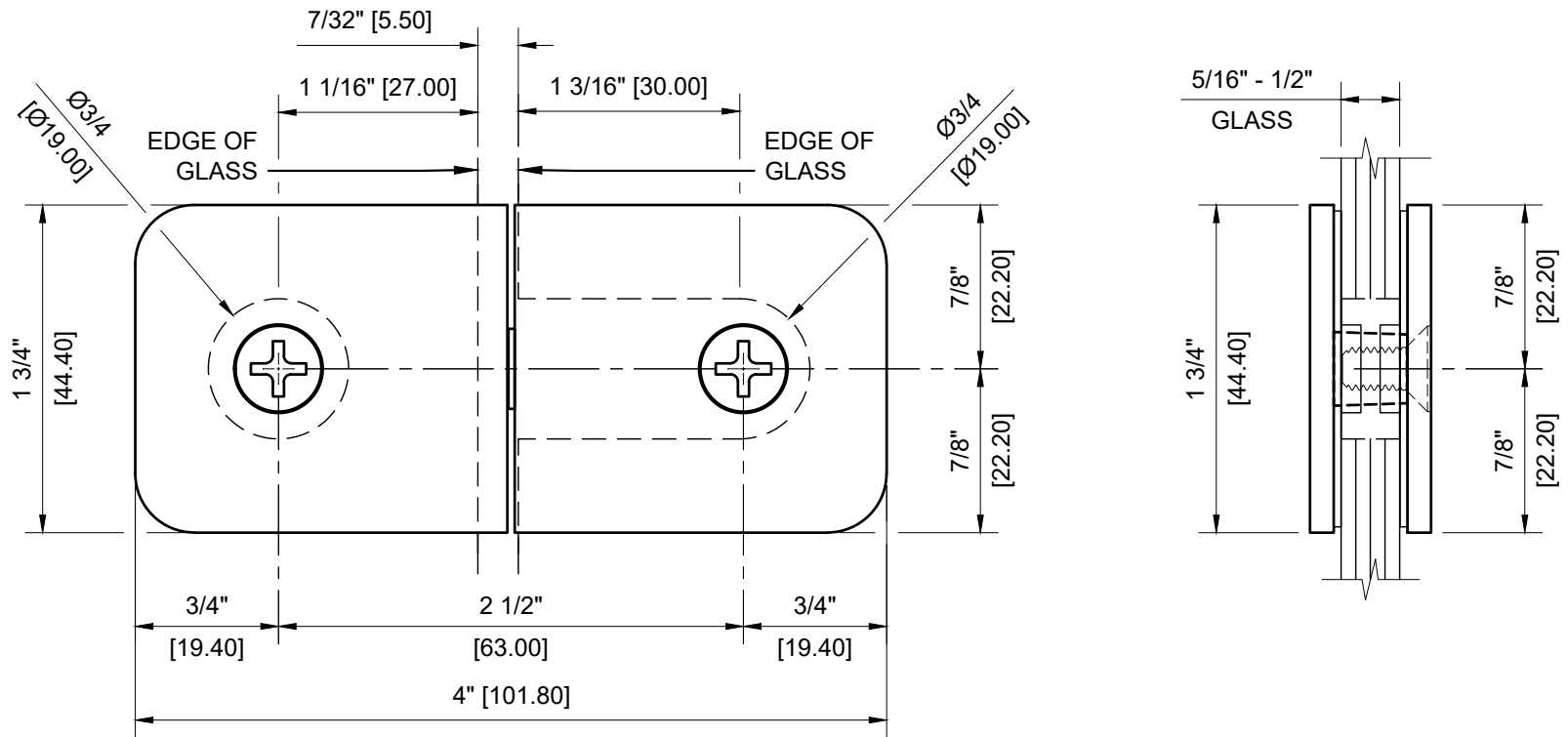

CRL - GCB188 180 DEGREE GLASS TO GLASS STANDARD MOVABLE TRANSOM 5/16" - 1/2" GLASS

DATE: 10-27-2020  
 SCALE: 1'-0"=1'-0"  
 DRAWN BY: VM

DESCRIPTION:  
 CRL - GCB188  
 180° MOVABLE GLASS TO GLASS  
 TRANSOM CLAMP

C.R. LAURENCE CO. ARCHITECTURAL PRODUCTS  
 2503 E. Vernon Avenue, Los Angeles, CA 90058-1897  
 PH (800)-421-6144 FX: 800-587-7501 www.crlaurence.com

