



Series 6000 XT Storefront

High performance design, built for demanding projects

Built for **versatility and high performance**, the Series 6000 XT storefront delivers next-generation thermal efficiency, offering **two levels of thermal performance** to meet today's evolving energy codes. Its **dual pour and debridge thermal break** not only **maximizes energy efficiency** but also **enhances condensation resistance**, ensuring long-term durability and occupant comfort. Designed to adapt to varying performance needs, the system supports **1" insulating glass** for enhanced efficiency or **1" thin triple insulating glass unit** for next-generation thermal performance, achieving **industry-leading energy savings while maintaining its familiar 2" x 6" depth**.

Designed for effortless installation, the Series 6000 XT features a **center-set glazing configuration, screw spline assembly, outside glazing** and a **high-performance sill receptor**. With **90° corner mullions** and **Red List Free** materials, the Series 6000 XT redefines what's possible - **delivering breakthrough energy efficiency while preserving installation simplicity and design flexibility**.

Series 6000 XT Storefront

Details

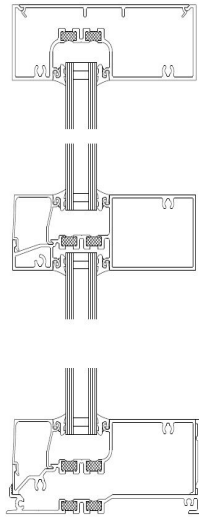

Double Pane Glazing

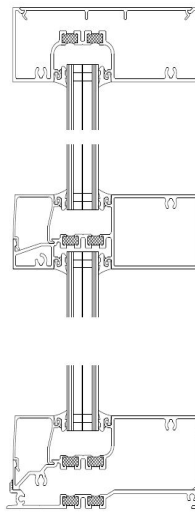
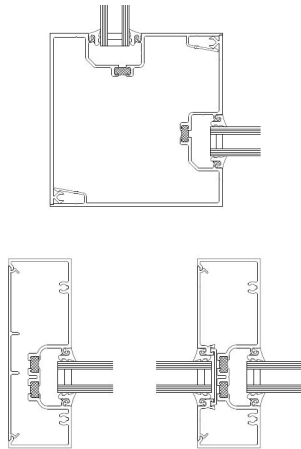

Thin Triple Pane Glazing

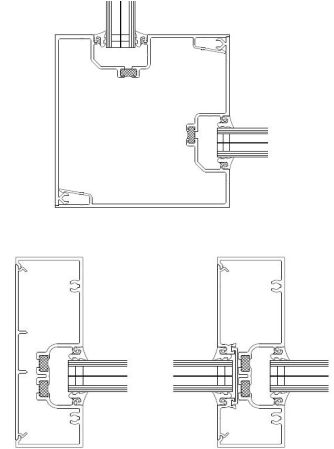

Features

System Dimensions: 2" x 6"

Infill Options: 1/4" - 1-1/8"

Outside glazing

Center set

Thermally broken using a dual pour and debridge pocket

Accepts 1" insulating glass or 1" thin triple insulating glass unit

Screw spline assembly

90° corner mullions

High performance sill receptor requires no additional anchoring of sill member

Accommodates zero sightline vents

Red List Free (optional)

Performance

Air Infiltration: <0.06 CFM/SQ FT (6.24PSF) per ASTM E283

Static Water: 10 PSF per ASTM E331

Deflection Load: 40 PSF per ASTM E330

Structural Load: 60 PSF per ASTM E330

STC per ASTM E90:

31 with clear 1" IGU; 38 with laminated 1" IGU

31 with clear 1" thin triple IGU

OITC per ASTM E90:

25 with clear 1" IGU; 31 with laminated 1" IGU

25 with clear 1" thin triple IGU

Thermal Performance per AAMA 1503:

Low-E 1" insulating glass:

U-factor = 0.32 / Frame CRF = 71

Low-E Thin Triple 1" insulating glass:

U-factor = 0.21 / Frame CRF = 76

Thermal Performance per NFRC 100:

1" Standard IGU:

U-factor = 0.28 - 0.49

1" Thin Triple IGU:

U-factor = 0.20 - 0.29

NFRC Certified and Thermal Performance Characteristics per AAMA 507

Finishes

Factory painted KYNAR 500/
HYLAR 5000 finishes, meeting all
provisions of AAMA 2605 & 2805

Factory-anodized finishing



Simplify your search with SystemSelect™

Compare thermal and visual performance details for entire architectural glass and metal systems quickly with our free online tool.

www.systemselect.obe.com

For more info: Contact your Oldcastle BuildingEnvelope® representative, visit us online at OBE.com, or call us at 1-866-OLDCASTLE (653-2278).



Oldcastle BuildingEnvelope®