

CRL ALUMINUM DOOR MOUNTED STANDARD PULL HANDLES

CRL GLASS MOUNTED SQUARE TUBE STYLE BACK-TO-BACK PULL HANDLE

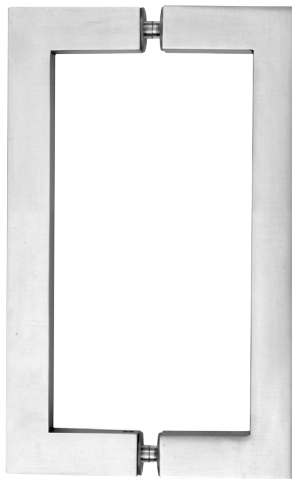

CAT. NO.
 SQ10X10
 SQ12X12
 SQ18X18
 SQ24X24

INCLUDED MOUNTING HARDWARE

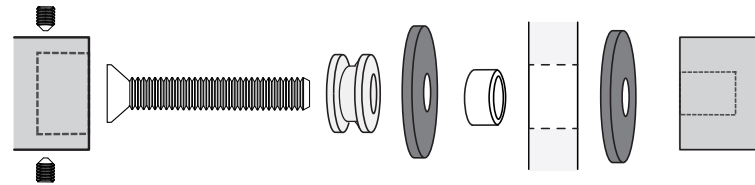

5/16"-18 Back-to-Back
 Glass Door Mount Shown

MOUNTING TEMPLATE

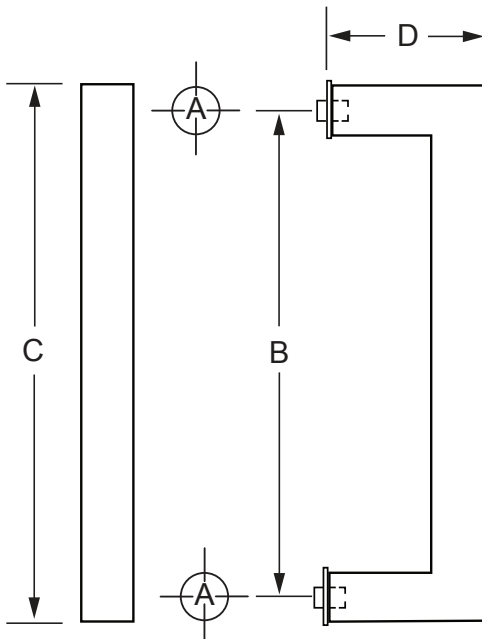

ADD TO CAT. NO. FOR FINISH
BS = BRUSHED STAINLESS
PS = POLISHED STAINLESS

CAT. NO.	Hole Size: A	B	C	D
	Glass			
SQ10X10	5/8" (16 mm)	10" (254 mm)	11" (279 mm)	2-7/8 (73 mm)
SQ12X12	5/8" (16 mm)	12" (305 mm)	13" (330 mm)	2-7/8 (73 mm)
SQ18X18	5/8" (16 mm)	18" (457 mm)	19" (483 mm)	2-7/8 (73 mm)
SQ24X24	5/8" (16 mm)	24" (610 mm)	25" (635 mm)	2-7/8 (73 mm)

Mounting Options	Glass 3/8"-3/4" (10-19 mm)	Wood/Aluminum up to 1-3/4" (45 mm)
Mounting Hardware	F40WK Included	Cat. No. TB4CH

NOTE: Optional hardware kits must be purchased separately.

