

INSTALLATION INSTRUCTIONS

CRL SCW103 CASHIER WINDOW



Phone: (800) 421-6144 • Ext. 17760 • Fax: (800) 587-7501
crlaurence.com • usalum.com • crl-arch.com
transaction@crlaurence.com

CRL SCW103 CASHIER WINDOW

ORDER OF ASSEMBLY AND INSTALLATION

INTRODUCTION/TOOLS REQUIRED 03

SUPPORTING WALL PREPARATION.....04-05

CASHIER WINDOW FRAME INSTALLATION.....06

CASHIER WINDOW AND SPEAK THRU INSTALLATION.....07

SEAL THE PERIMETER.....08

CONCLUSION.....09

The rapidly changing technology within the architectural aluminum products industry demands that C.R. Laurence/U.S. Aluminum reserve the right to revise, discontinue, or change any product line, specification, or electronic media without prior written notice.

NOTE: Dimensions in parentheses () are millimeters unless otherwise noted.

CRL SCW103 CASHIER WINDOW

INTRODUCTION

Our **CRL Cashier Window** unit is ready for immediate installation. The standard SCW103N includes an aluminum framed stationary 1/4" (6 mm) clear tempered glass window, and Cat. No. 834A Speak-Thru. This sits atop a stainless steel shelf measuring 30" (762 mm) wide x 18" (457 mm) deep x 2" (51 mm) thick. Standard unit is shipped attached to stainless steel shelf, projecting 12" to outside and 6" to inside from center line of glass. SCW103C custom units may or may not have a shelf, and projection may vary.

IMPORTANT: PLEASE READ BEFORE INSTALLING WINDOW

The Following Instructions Will Reduce Your Chances of Experiencing Problems During Installation

Window Checklist

Remove the window from the package and inspect. Advise CRL immediately if any damage is noted. Confirm the frame is square: if necessary, re-tighten corner screws if they have loosened during transit.

Materials Included

Window and Components

Materials Recommended (Not Included)

Cordless Drill

Caulking Gun

Screw Driver

CRL Cat. No. 199 Utility Knife

CRL Cat. No. M64 Construction Sealant (Select Color)

CRL Cat. No. NWS9 Tapered Wood Shims

CRL Cat. No. 1973 Glass Cleaner

CRL Cat. No. 1550 Lint Free Shop Towels

Fasteners / Anchors By Installer Based On Field Conditions

Installation Requirements

All windows must be installed plumb and square. Based on the wall substrate, correct anchors and screws must be used to properly secure the window into the opening.

Installation Procedures

Check the opening to be sure it is square and has the proper clearances.

Wall opening width is recommended 1/2" minimum more than the window width.

Wall opening height is recommended 1/4" minimum more than the window height.

Drill holes in the mainframe jambs and header every 6"-to-8" for fasteners appropriate for the substrate. Countersinking is not necessary for the SCW window frame, because the channel where the screws are located has a Snap-On Cover.

NOTE: Modifications, other than those specified in this document, may void the manufacturer's warranties.

CRL SCW103 CASHIER WINDOW

SUPPORTING WALL PREPARATION

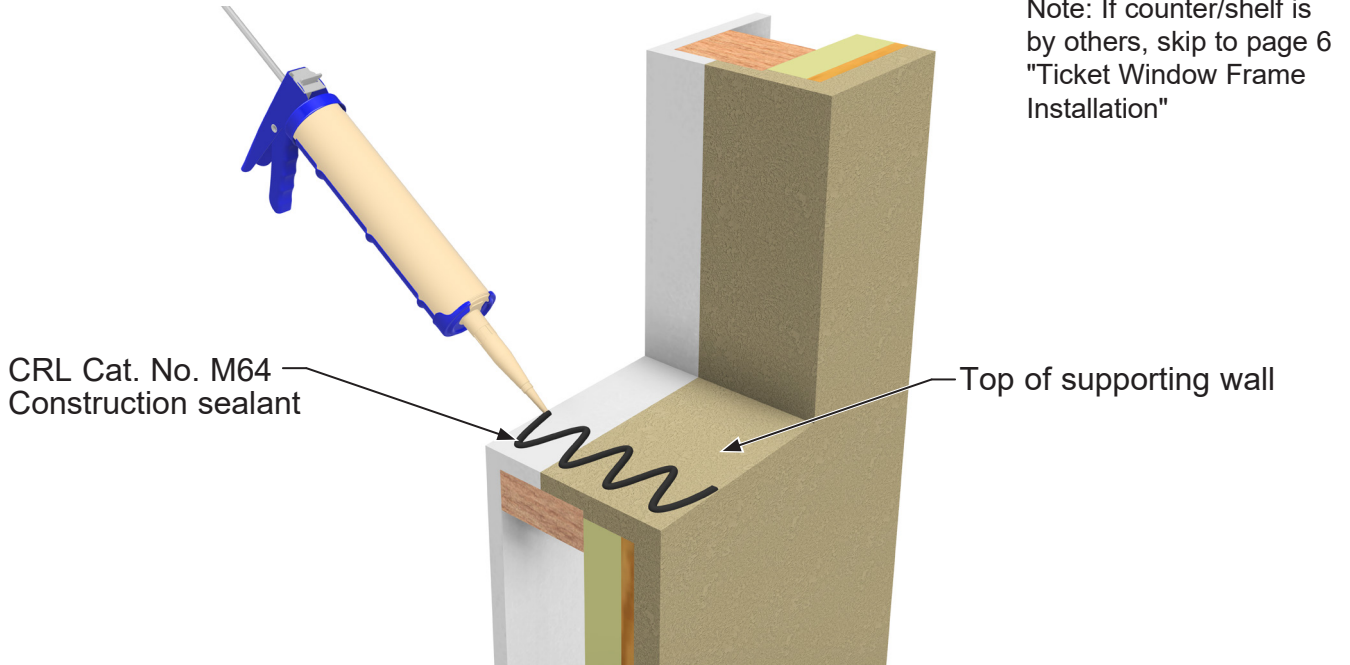

1. Apply **CRL Cat. No. M64** construction sealant between the shelf's bottom plate and the top of the supporting wall for additional strength.

UNDER-SHELF INSTALLATION (OPTION "A")

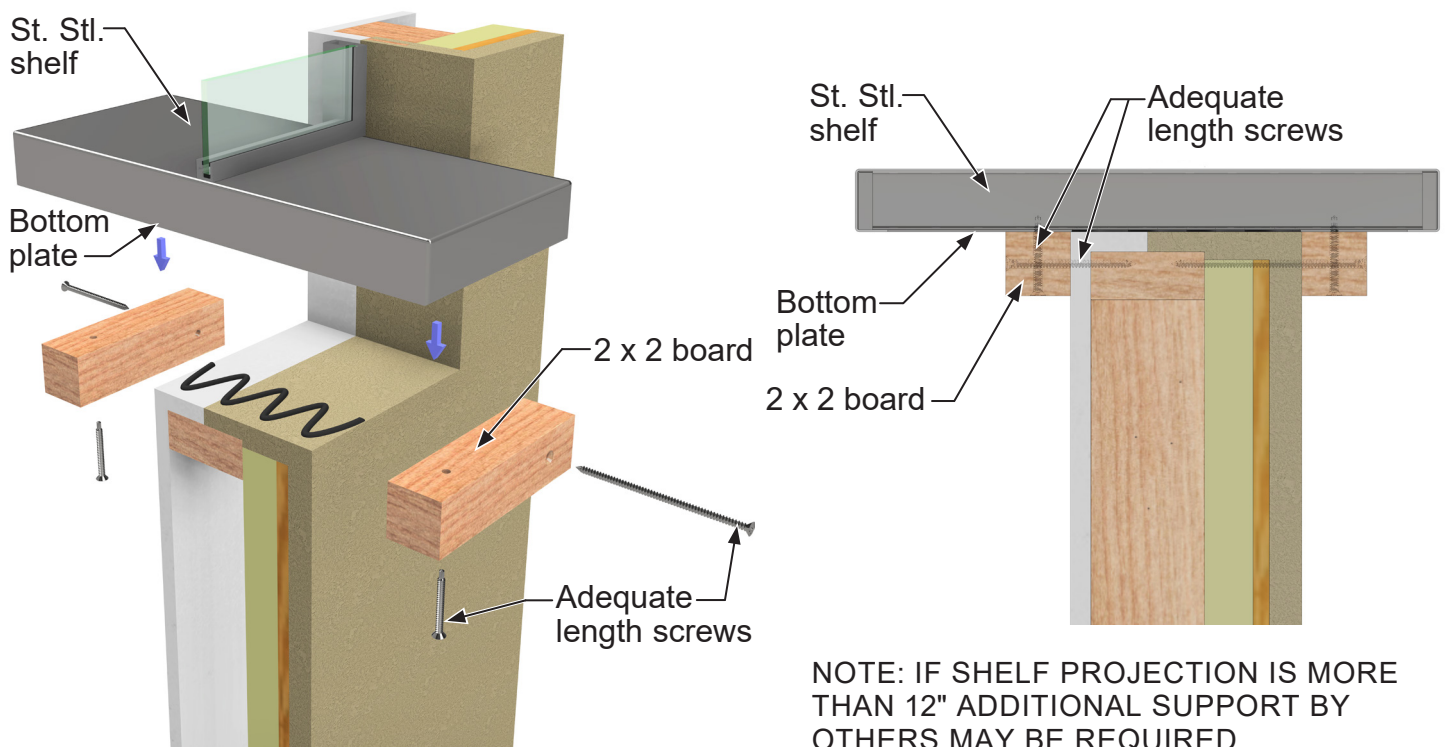

- A. Drill and countersink 2" x 2" boards in the appropriate attachment area. Secure the 2 x 2 boards to both sides of the wall even with the bottom of the opening. Secure the shelf from the underside using screws of adequate length (not included).

CRL SCW103 CASHIER WINDOW

UNDER-SHELF INSTALLATION USING ST. STL. BRACKETS (OPTION "B")

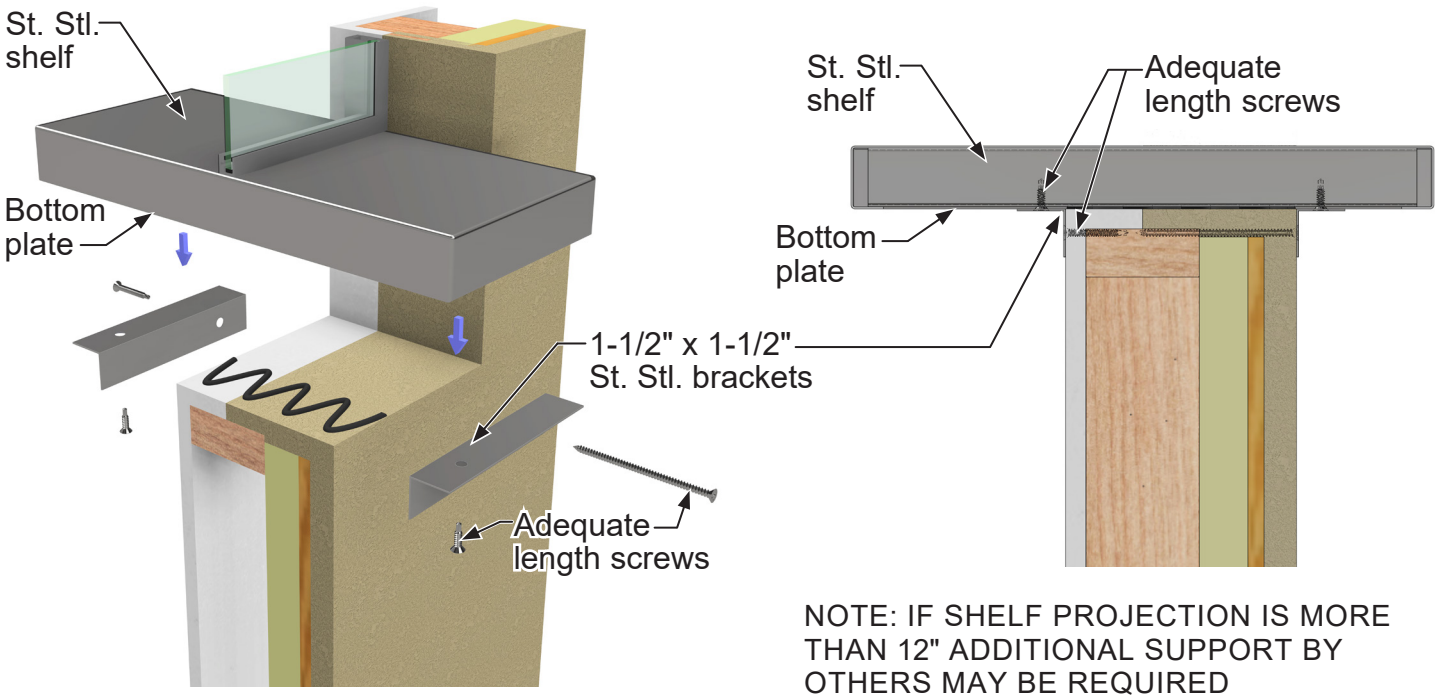

- B. Drill and countersink 1-1/2" x 1-1/2" St. Stl. brackets in the appropriate attachment area. Secure the 1-1/2" x 1-1/2" St. Stl. brackets to both sides of the wall even with the bottom of the opening. Secure the shelf from the underside using screws of adequate length (not included).

STAINLESS STEEL BRACKETS (OPTIONAL)

Stainless Steel Shelf Brackets are available in seven lengths from 24" to 96". They are made from 1-1/2" x 1-1/2" 16 gauge brushed stainless steel angle to match the shelf finish. Brackets are not drilled, so the installer has the option of drilling holes only where they are needed. Brackets are sold only in pairs.

CRL Shelf Brackets

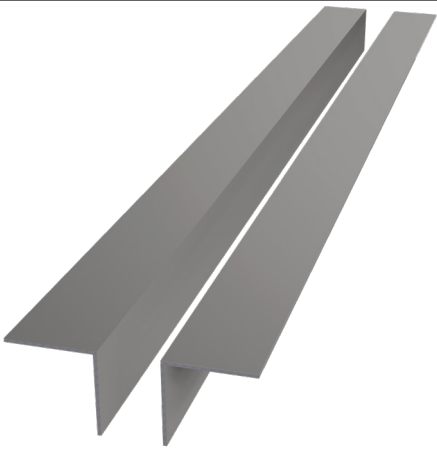
CAT. NO. LENGTH		
SSSB24	24"	
SSSB30	30"	
SSSB36	36"	
SSSB48	48"	
SSSB60	60"	
SSSB72	72"	
SSSB96	96"	

CRL SCW103 CASHIER WINDOW

CASHIER WINDOW FRAME INSTALLATION

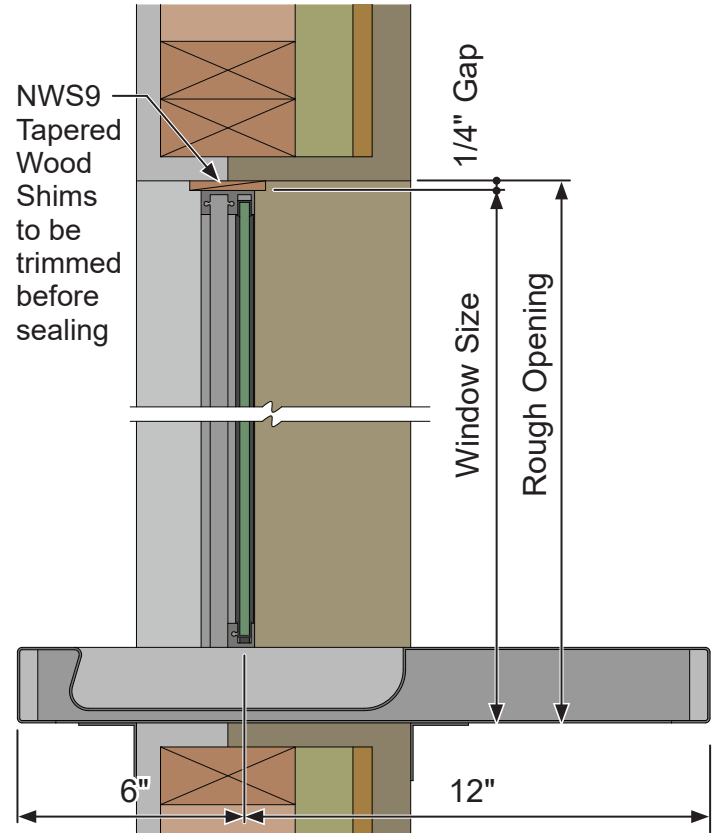
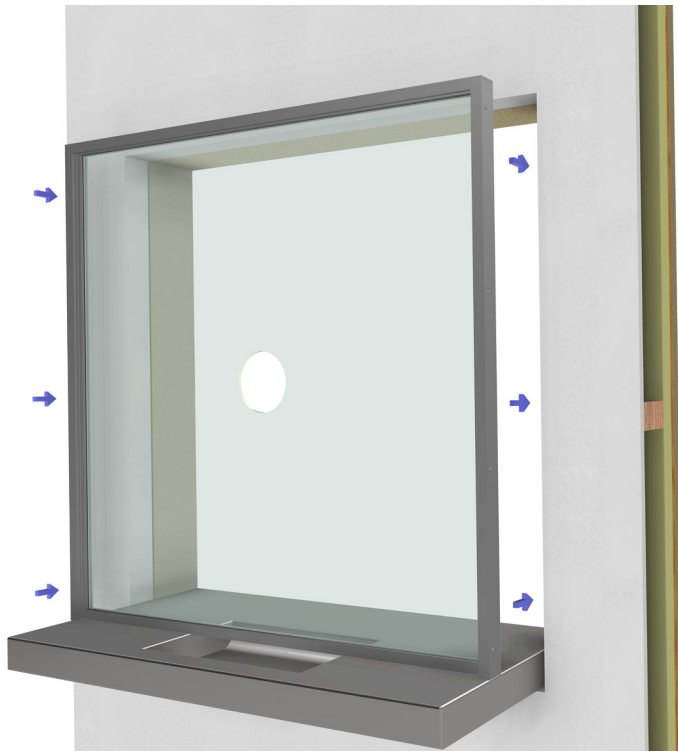

2. Insert the cashier window frame (including shelf) into the opening, with the bottom of the shelf setting flush on the bottom of the opening. (If the counter/shelf is by others, set the bottom of the frame flush to the counter/shelf by others). Starting at the top, shim down both sides with CRL Cat. No. NWS9 Tapered Wood Shims (not included) at equal intervals paired on inside and outside. Drive screws through the jambs without tightening all the way. Gently tap shims together to achieve a tight fit, confirming frame remains square in the opening with equal gaps all around. Tighten jamb screws and repeat procedure at header.

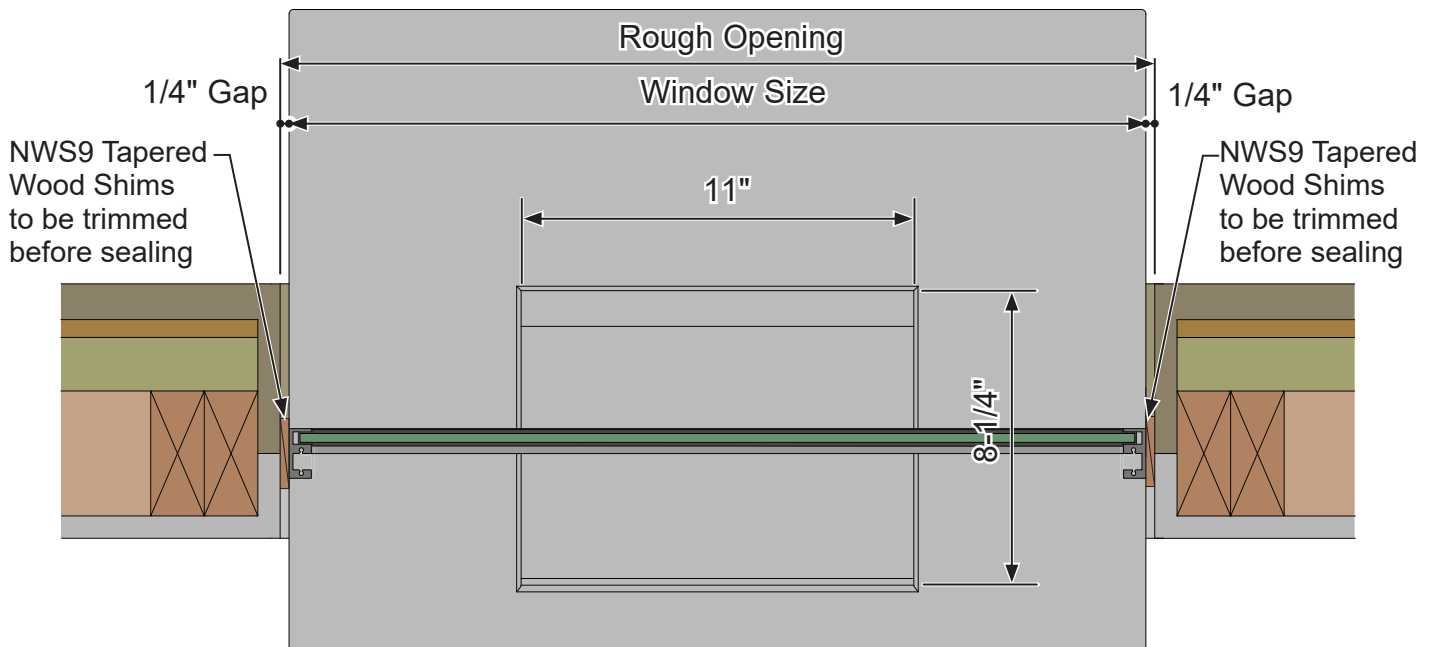

CRL SCW103 CASHIER WINDOW

CASHIER WINDOW FRAME INSTALLATION

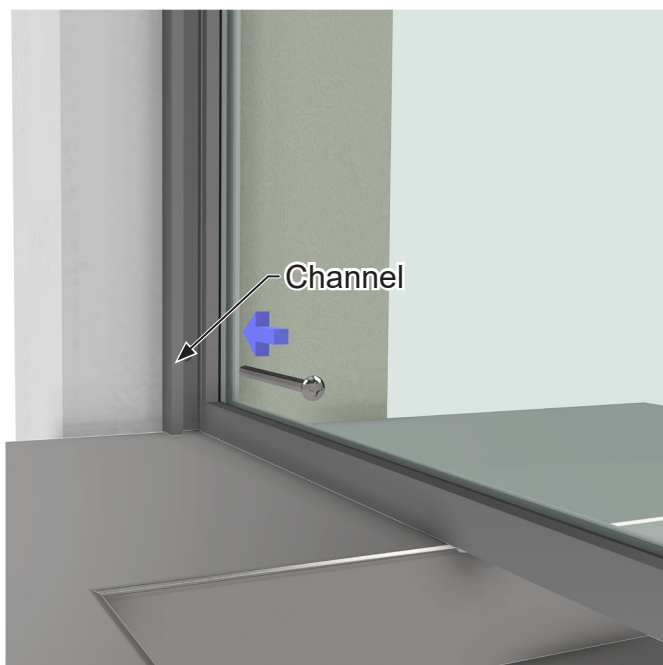

3. After the frame is secured, use CRL Cat. No. 199 Utility Knife (not included) to trim ends of wood shims in preparation for sealing frame.

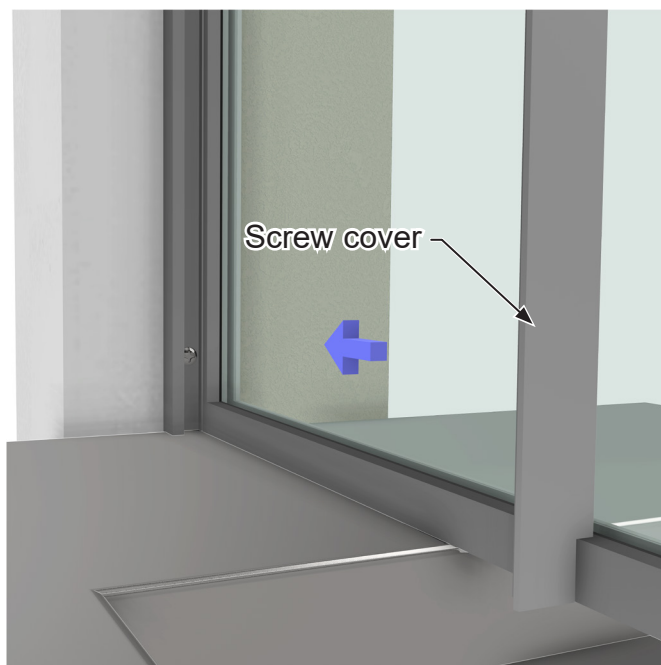

4. After the trimming has been completed, snap in the screw covers.

SPEAK THRU INSTALLATION

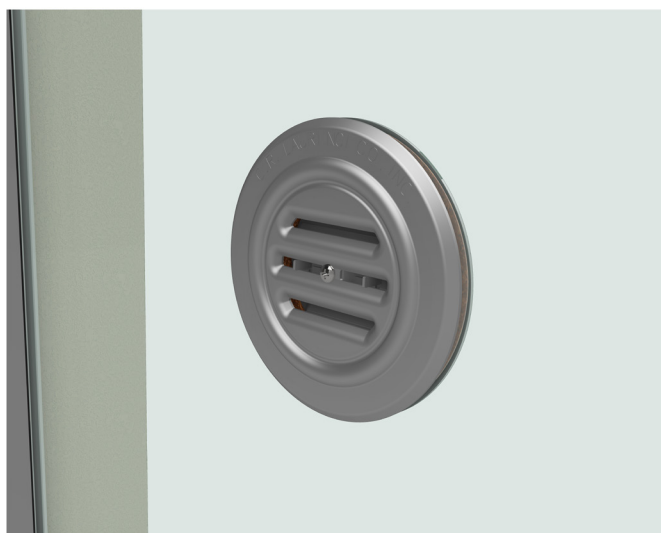
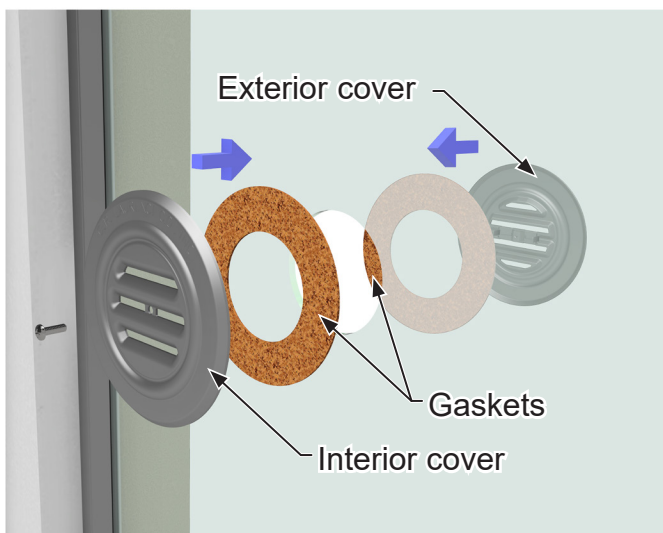

5. The Speak Hole Cover is packaged separately during shipping, inside the window package. Remove the screw, and separate the interior and exterior covers and gaskets. Insert the exterior cover and gasket on the glass cut out from the exterior side. Place the interior cover and gasket on the glass cutout from the interior side. Secure by fastening the screw through the interior cover and tighten.

CRL SCW103 CASHIER WINDOW

SEAL THE PERIMETER

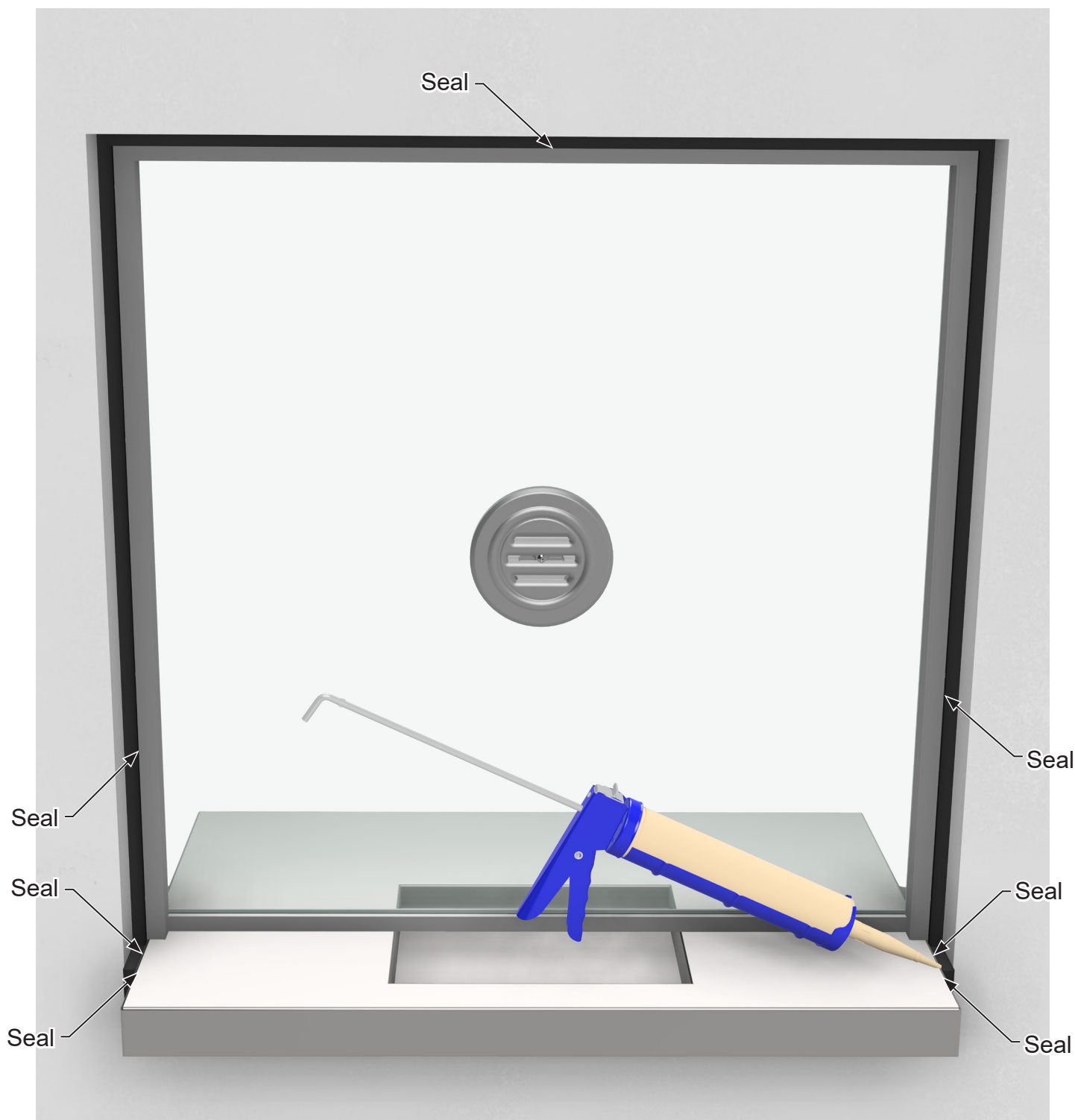

6. Seal the exterior and interior perimeters using **CRL Cat. No. M64** construction sealant.
7. Clean the window thoroughly with **CRL Cat. No. 1973** Glass Cleaner (not included) and **CRL Cat. No. 1550** Lint Free Shop Towels (not included).

CRL SCW103 CASHIER WINDOW

This Concludes the Installation Manual for your product. We hope that this guide has been helpful. Should you need further assistance, our knowledgeable Technical Sales Department is available at no charge during regular business hours. Please have your Order Number ready before calling.



"WE'RE HERE TO
HELP"
TECHNICAL SALES
1-323-588-1281

Or Visit our Websites at:
www.crlaurence.com or
www.usalum.com

Glass and Glazing AssistanceExt: 15275
Tools, Hardware, Sealants, Safety Gear, U.V., and Equipment

Architectural HardwareExt: 17700
Entrances and Storefronts, Balanced, Stacking, and Sliding Doors

Architectural and Ornamental Metals.....Ext: 17700
Formed Sheet Metal, Awnings, Columns, and Wall Panels

Shower DoorsExt: 17740
Hinges, Handles, Enclosures, Grab Bars, and Partitions

Transaction and Hospitality.....Ext: 17760
Bullet Resistant, Drive Thru, Sneeze Guards, and Ticket Windows

Door and Window Control Hardware.....Ext: 17520
Jackson Overhead Concealed Closers, Surface Closures, Locks

Blumcraft Architectural MetalsExt: 17700
Tempered Glass Doors, Panic Hardware, Glass Gates, and Baffles

U.S. AluminumExt: 15305
Storefronts, Entrances, Curtain Walls, Window Walls, and Partitions

Architectural RailingsExt: 17730
Cap, Hand, Post, Wind Screen, Base Shoe, and TaperLoc

Automotive.....Ext: 17780
Automotive Glazing Supplies, Truck Sliders, and RV Windows