

PART NUMBER	FINISH	L1	L2
BMNW6X12CH	CHROME	6" 152mm	12" 309mm
BMNW6X12BR	POLISHED BRASS	6" 152mm	12" 309mm
BMNW6X120RB	OIL RUBBED BRONZE	6" 152mm	12" 309mm
BMNW6X12BN	BRUSHED NICKEL	6" 152mm	12" 309mm
BMNW6X12BSC	BRUSHED SATIN CHROME	6" 152mm	12" 309mm
BMNW6X12PN	POLISHED NICKEL	6" 152mm	12" 309mm
BMNW6X12SC	SATIN CHROME	6" 152mm	12" 309mm
BMNW6X12W	WHITE	6" 152mm	12" 309mm

BMNW6X18CH	CHROME	6" 152mm	18" 457mm
BMNW6X18BR	POLISHED BRASS	6" 152mm	18" 457mm
BMNW6X180RB	OIL RUBBED BRONZE	6" 152mm	18" 457mm
BMNW6X18BN	BRUSHED NICKEL	6" 152mm	18" 457mm
BMNW6X18BSC	BRUSHED SATIN CHROME	6" 152mm	18" 457mm
BMNW6X18PN	POLISHED NICKEL	6" 152mm	18" 457mm
BMNW6X18SC	SATIN CHROME	6" 152mm	18" 457mm
BMNW6X18W	WHITE	6" 152mm	18" 457mm
BMNW6X18SN	SATIN NICKEL	6" 152mm	18" 457mm
BMNW6X18SB	SATIN BRASS	6" 152mm	18" 457mm

BMNW6X22CH	CHROME	6" 152mm	22" 559mm
BMNW6X22BR	POLISHED BRASS	6" 152mm	22" 559mm
BMNW6X220RB	OIL RUBBED BRONZE	6" 152mm	22" 559mm
BMNW6X22BN	BRUSHED NICKEL	6" 152mm	22" 559mm
BMNW6X22BSC	BRUSHED SATIN CHROME	6" 152mm	22" 559mm
BMNW6X22PN	POLISHED NICKEL	6" 152mm	22" 559mm
BMNW6X22SC	SATIN CHROME	6" 152mm	22" 559mm
BMNW6X22W	WHITE	6" 152mm	22" 559mm
BMNW6X22SB	SATIN BRASS	6" 152mm	22" 559mm
BMNW6X22MBL	MATTE BLACK	6" 152mm	22" 559mm
BMNW6X22SN	SATIN NICKEL	6" 152mm	22" 559mm

BMNW6X24CH	CHROME	6" 152mm	24" 610mm
BMNW6X24BR	BRASS	6" 152mm	24" 610mm
BMNW6X240RB	OIL RUBBED BRONZE	6" 152mm	24" 610mm
BMNW6X24BN	BRUSHED NICKEL	6" 152mm	24" 610mm
BMNW6X24BSC	BRUSHED SATIN CHROME	6" 152mm	24" 610mm
BMNW6X24PN	POLISHED NICKEL	6" 152mm	24" 610mm
BMNW6X24SC	SATIN CHROME	6" 152mm	24" 610mm
BMNW6X24W	WHITE	6" 152mm	24" 610mm
BMNW6X24SB	SATIN BRASS	6" 152mm	24" 610mm

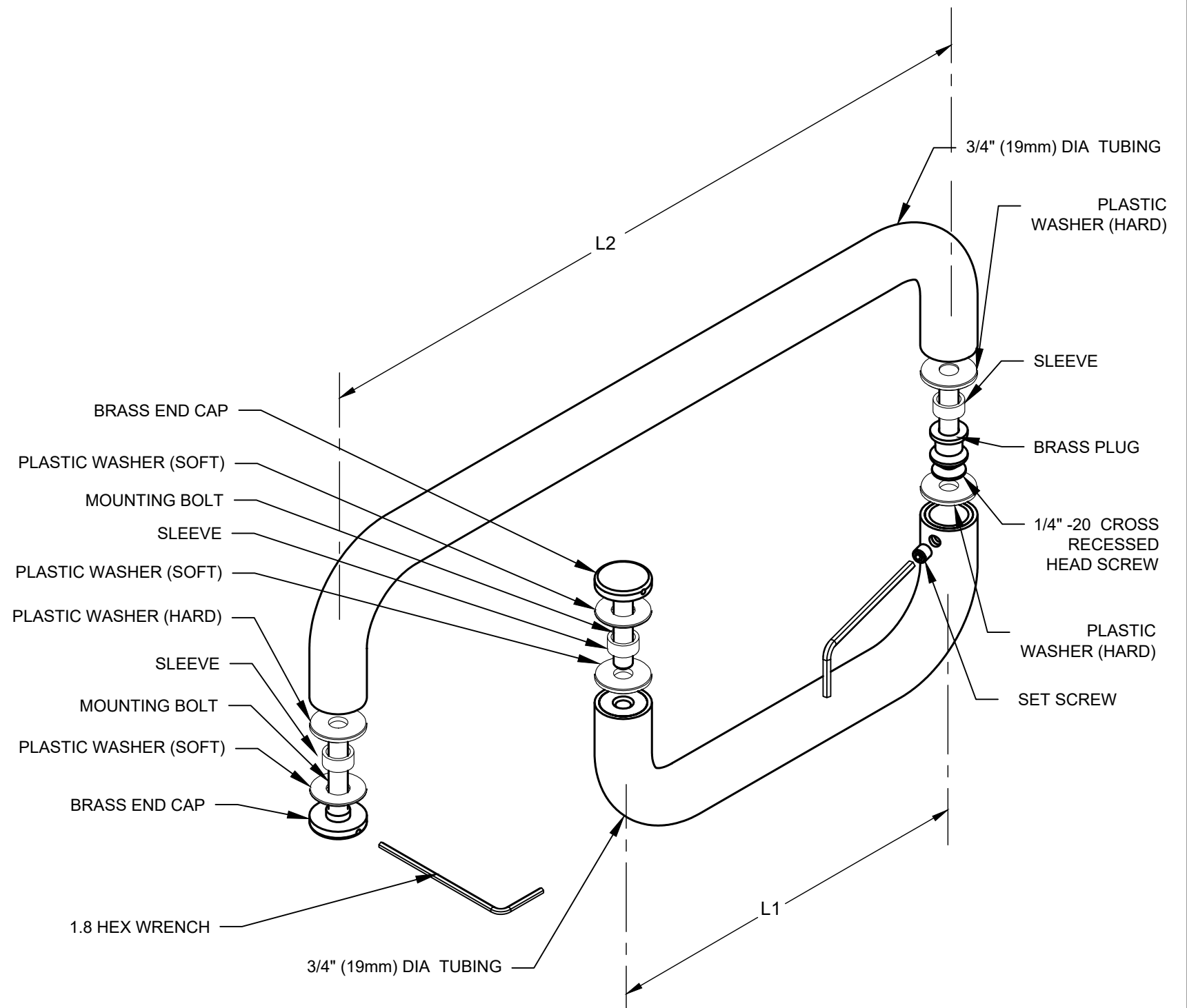

Material: 3/4" (19mm) dia. Brass Tubing .060" (2mm) thk.
 1-1/4" (32mm) dia. metal washers
 Glass Thickness Range: 3/8" to 1/2" (10mm - 13mm)
 Hole Diameter Required: 1/2" (13mm)



C.R. LAURENCE CO.
 ARCHITECTURAL PRODUCTS
 PH (800)-421-6144 FX: 800-587-7501
 www.crlaurence.com

DESCRIPTION:

BMNW HANDLE & TOWEL BAR COMBINATION

PART #: SEE CHART
 FILE NAME: BMNW COMBO
 DRAWN BY: BRIAN R.

DATE: 10/30/18
 SCALE: NTS

PART NUMBER	FINISH	L1		L2	
BMNW8X18CH	CHROME	8"	203mm	18"	457mm
BMNW8X18BR	POLISHED BRASS	8"	203mm	18"	457mm
BMNW8X18ORB	OIL RUBBED BRONZE	8"	203mm	18"	457mm
BMNW8X18BN	BRUSHED NICKEL	8"	203mm	18"	457mm
BMNW8X18BSC	BRUSHED SATIN CHROME	8"	203mm	18"	457mm
BMNW8X18PN	POLISHED NICKEL	8"	203mm	18"	457mm
BMNW8X18SC	SATIN CHROME	8"	203mm	18"	457mm
BMNW8X18W	WHITE	8"	203mm	18"	457mm
BMNW8X18SN	SATIN NICKEL	8"	203mm	18"	457mm
BMNW8X18SB	SATIN BRASS	8"	203mm	18"	457mm

BMNW8X22CH	CHROME	8"	203mm	22"	559mm
BMNW8X22BR	POLISHED BRASS	8"	203mm	22"	559mm
BMNW8X22ORB	OIL RUBBED BRONZE	8"	203mm	22"	559mm
BMNW8X22BN	BRUSHED NICKEL	8"	203mm	22"	559mm
BMNW8X22BSC	BRUSHED SATIN CHROME	8"	203mm	22"	559mm
BMNW8X22PN	POLISHED NICKEL	8"	203mm	22"	559mm
BMNW8X22SC	SATIN CHROME	8"	203mm	22"	559mm
BMNW8X22W	WHITE	8"	203mm	22"	559mm
BMNW8X22SN	SATIN NICKEL	8"	203mm	22"	559mm

BMNW8X24ORB	OIL RUBBED BRONZE	8"	203mm	24"	610mm
BMNW8X24ABC0	ANTIQUÉ BRUSH COPPER	8"	203mm	24"	610mm
BMNW8X24BN	BRUSHED NICKEL	8"	203mm	24"	610mm
BMNW8X24BR	POLISHED BRASS	8"	203mm	24"	610mm
BMNW8X24BSC	BRUSHED SATIN CHROME	8"	203mm	24"	610mm
BMNW8X24CH	POLISHED CHROME	8"	203mm	24"	610mm
BMNW8X24PN	POLISHED NICKEL	8"	203mm	24"	610mm
BMNW8X24SB	SATIN BRASS	8"	203mm	24"	610mm
BMNW8X24SC	SATIN CHROME	8"	203mm	24"	610mm
BMNW8X24SN	SATIN NICKEL	8"	203mm	24"	610mm
BMNW8X24W	WHITE	8"	203mm	24"	610mm

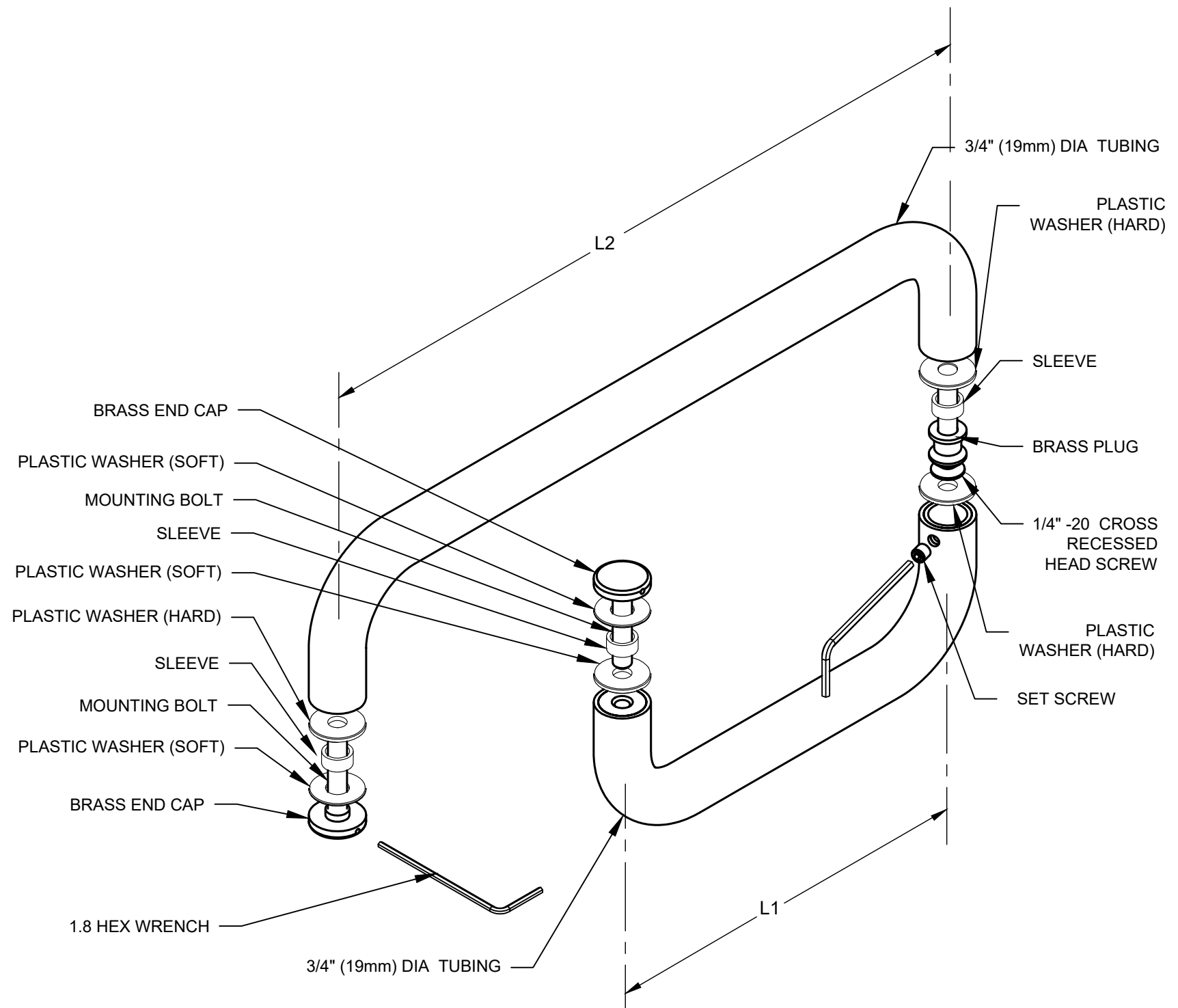

Material: 3/4" (19mm) dia. Brass Tubing .060" (2mm) thk.
1-1/4" (32mm) dia. metal washers
Glass Thickness Range: 3/8" to 1/2" (10mm - 13mm)
Hole Diameter Required: 1/2" (13mm)



C.R. LAURENCE CO.
ARCHITECTURAL PRODUCTS
PH (800)-421-6144 FX: 800-587-7501
www.crlaurence.com

DESCRIPTION:

BMNW HANDLE / TOWEL BAR COMBINATION

PART #: SEE CHART
FILE NAME: BMNW COMBO
DRAWN BY: BRIAN R.

DATE: 10/30/18
SCALE: NTS