

CRL ALUMINUM DOOR MOUNTED STANDARD PULL HANDLES

CRL 12" GLASS MOUNTED CURVED PULL HANDLE



CAT. NO.
CC12X12

INCLUDED MOUNTING HARDWARE

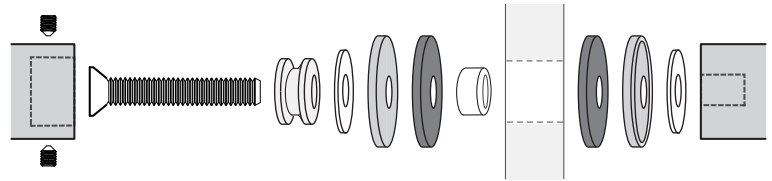

MOUNTING TEMPLATE

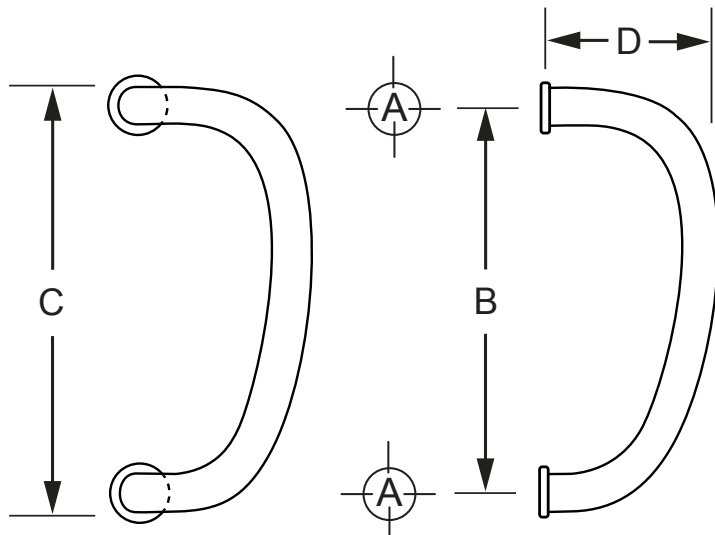

ADD TO CAT. NO. FOR FINISH
BR = POLISHED BRASS
BS = BRUSHED STAINLESS
PS = POLISHED STAINLESS
DU = DARK BRONZE

Hole Size: A		B	C	D
Glass 5/8" (16 mm)	Wood/Aluminum 5/16" (8 mm)	12" (305 mm)	13" (330 mm)	3" (76 mm)

Mounting Options	Glass 3/8"-3/4" (10 to 19 mm)	Wood/Aluminum up to 1-3/4" (45 mm)
Mounting Hardware	Cat. No. F40WK Included	Cat. No. TB4CH

NOTE: Optional hardware kits must be purchased separately.

