

Revisions By:

**CRL**<sup>®</sup>

Description  
**ENTICE  
SINGLE & DOUBLE  
DOORS**

Drawn by:

Date:

Scale:

File name:

Sheet

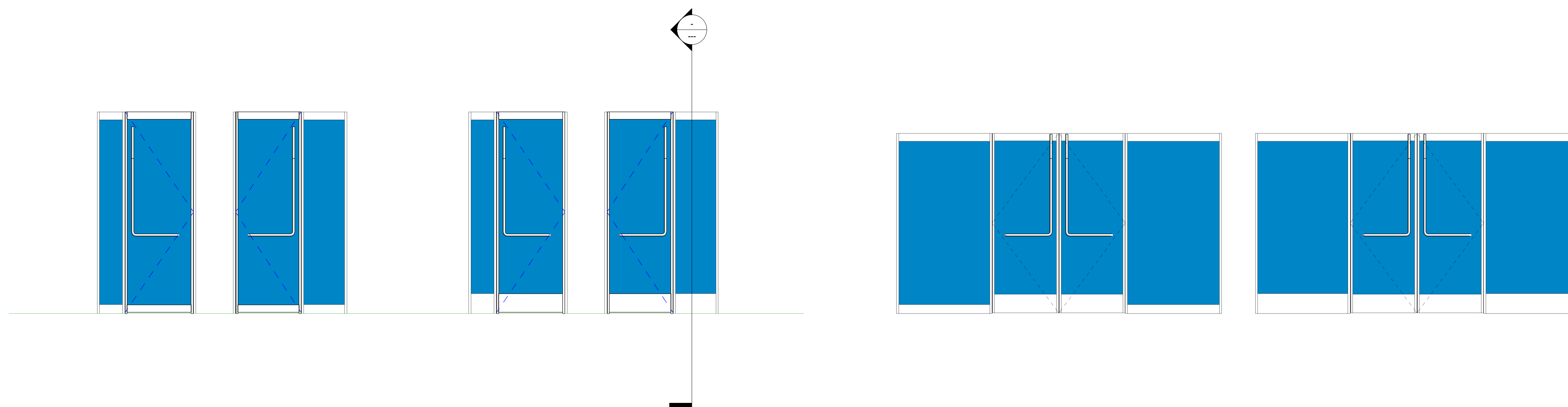

1 South  
3/8" = 1'-0"

To bring everything to your project:  
 \*Select all walls inside the drawn rectangle  
 \*Ctrl-V to paste onto your project.

Now you have these options embedded

(Note you might need to cut out your solid wall and modify the face to insert the "revit curtain wall" in order to bring these in. Check Sample)

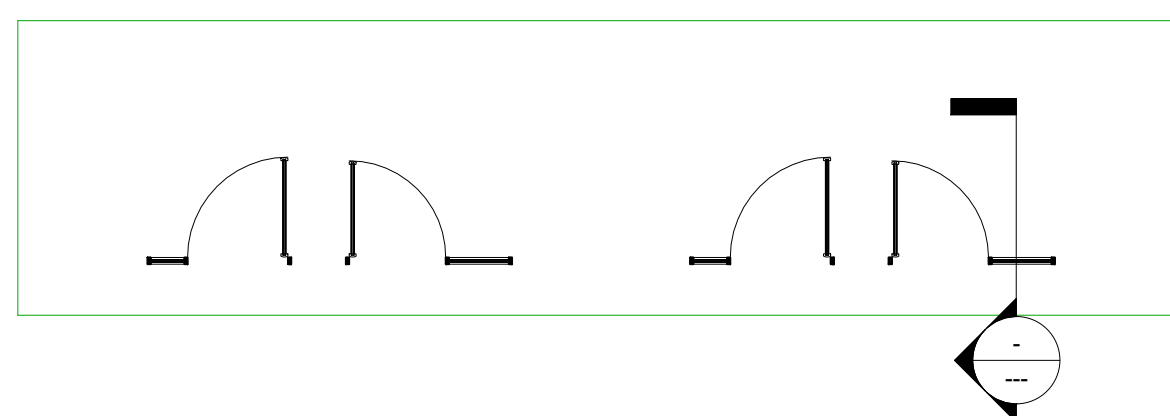

Entice Doors  
4" Bottom Rail

Entice Doors  
10" Bottom ADA Rail



Entice Double Doors  
4" Bottom Rail

Entice Double Doors  
10" Bottom ADA Rail

SAMPLE:



\*Edit face profile on your wall



\*add curtain wall wall

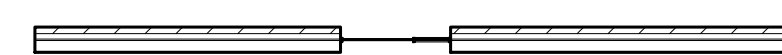

\*delete top and bottom mullions where door will be

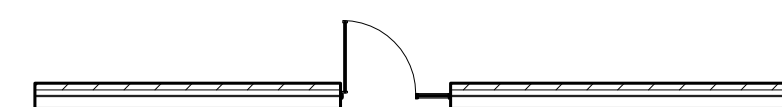

\*select glaze panel and replace with door family from properties menu

2 Level 1  
3/16" = 1'-0"

3 Directions  
1/8" = 1'-0"