

INSTALLATION INSTRUCTIONS

SHEET 1 OF 2

6 X 10 PUSH BUTTON CENTER LOCK DL610LC, DL610RC, DL611LC, DL611RC

* REFERS TO L1000 INSTALLATION INSTRUCTION
HANDBOOK FROM ILCO UNICAN

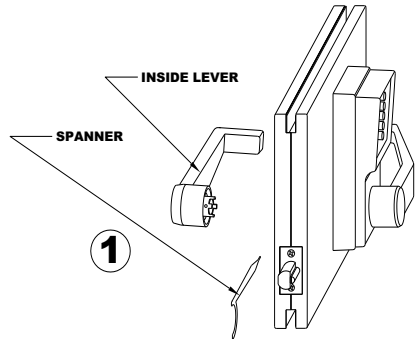

REMOVE INSIDE LEVER BY INSERTING POINT OF SPANNER INTO POKEHOLE IN COLLAR OF DRIVE SLEEVE AND DEPRESSING RETAINING CLIP.

* SEE STEP 10. INSTALLING INSIDE LEVER

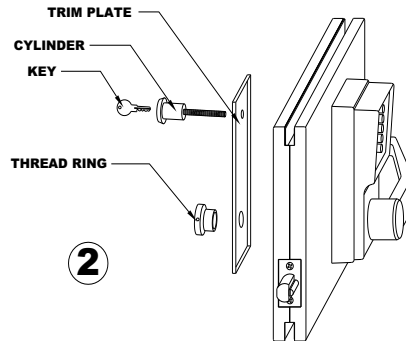

REMOVE CYLINDER BY INSERTING KEY AND ROTATING CYLINDER ANTI-CLOCKWISE UNTIL IT IS FREE.

* SEE STEP 11. INSTALLING COMBINATION CHANGE PLUG ASSEMBLY

REMOVE INSIDE TRIM PLATE BY UNSCREWING THREAD RING FROM DRIVE UNIT.

* SEE STEP 9. INSTALLING INSIDE TRIM PLATE.

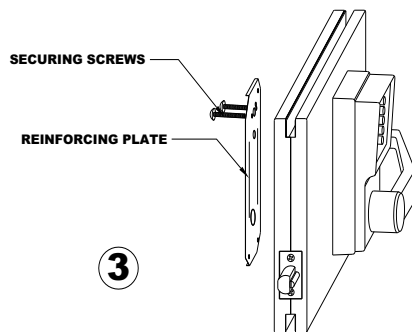

REMOVE REINFORCING PLATE BY UNSCREWING THE TWO SECURING SCREWS

* SEE STEP 7. INSTALLING REINFORCING PLATE.

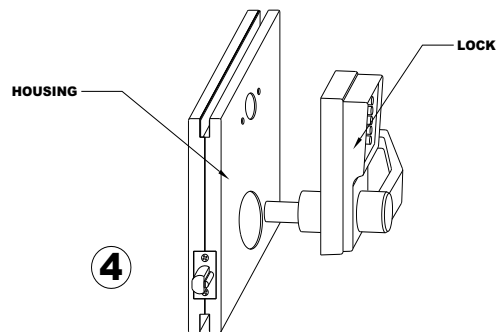

REMOVE LOCK BY SLIDING IT FROM THE HOUSING.

* SEE STEP 5. INSTALLING LOCK.

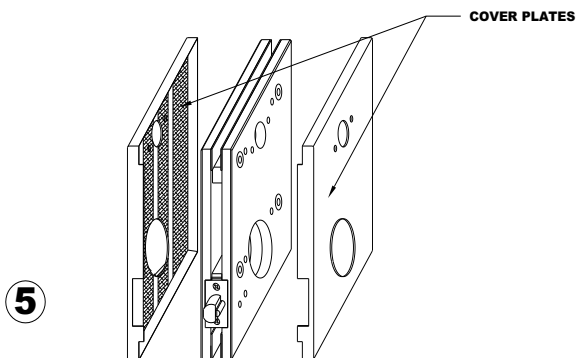

REMOVE COVER PLATES

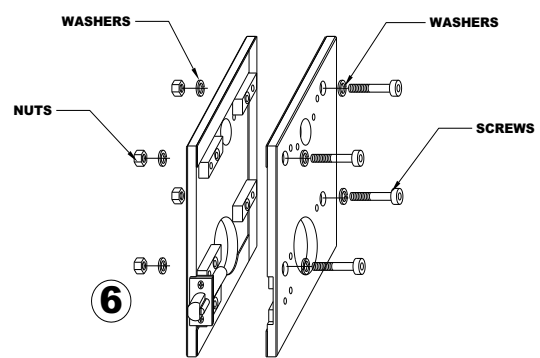

SEPARATE CLAMP PLATES BY REMOVING 4 CAP HEAD SCREWS NUTS AND WASHERS.

INSTALLATION INSTRUCTIONS

6 X 10 PUSH BUTTON CENTER LOCK

DL610LC, DL610RC, DL611LC, DL611RC

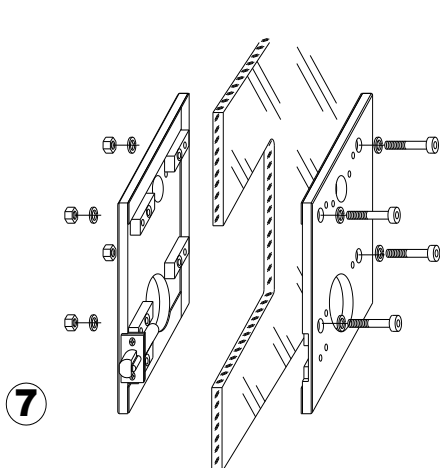

7

**ASSEMBLE CLAMP PLATES ONTO GLASS.
BE SURE TO HAVE NUTS AND WASHERS ON THE OUTSIDE**

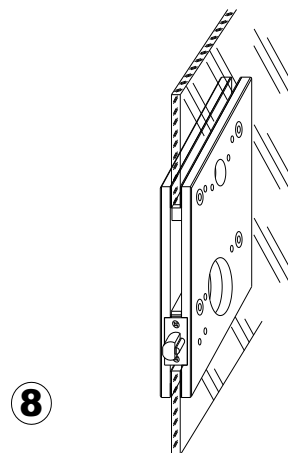

8

**NOTE: BEFORE FINALLY TIGHTENING, TEST INSTALL THE
COVER PLATES TO ENSURE ALIGNMENT WITH GLASS.**

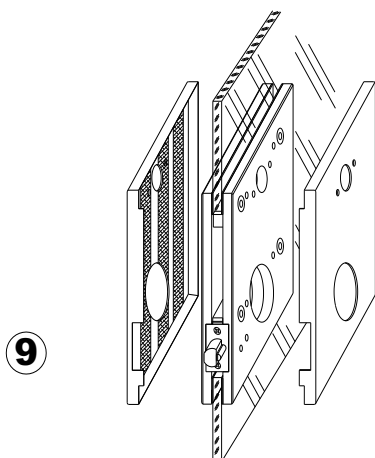

9

**REMOVE VHB TAPE COVER PAPER
CAREFULLY APPLY COVER PLATES ENSURING HOLES
AND LOCK FACE PLATE LINE UP. PRESS ON FIRMLY.**

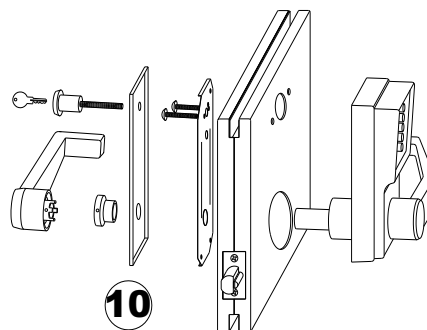

10

RE-ASSEMBLE LOCK AND HARDWARE.

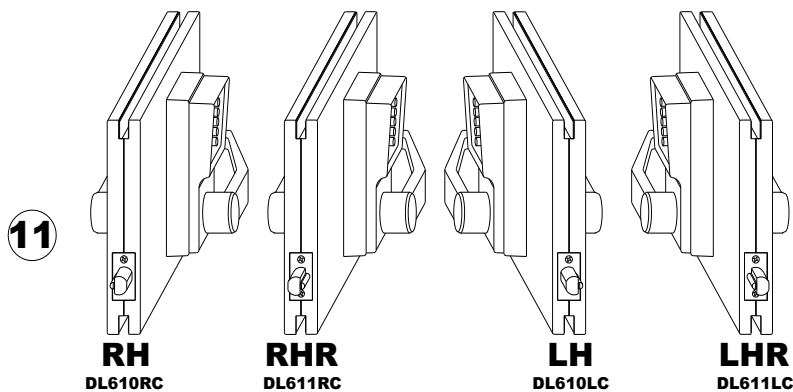

*** ENSURE LOCK HAS BEEN ASSEMBLED TO THE CORRECT HAND. FOLLOW DIRECTIONS
IN THE ILCO UNICAN INSTALLATION BOOK. SET UP COMBINATION AND TEST LOCK
OPERATION AS DESCRIBED IN SECTION 13.**