

| | |
|---------------------------------|-------------|
| COMPANY NAME _____ | PHONE _____ |
| CONTACT _____ ACCOUNT NO. _____ | FAX _____ |
| JOB NAME _____ | EMAIL _____ |

QUOTE ORDER P.O. # _____ DATE _____

MODEL / RATING

- Light Interlock (Interior Use)
- Heavy Interlock (CW40 Rating) Exterior Use

GLAZING

- By Others
- By C.R. Laurence Specify (Color/Type) _____

STANDARD HARDWARE FINISH

- Brushed Stainless Steel
- White Painted
- Black Painted

FINISHES

- Available color/finish options:
- WH - White Powder Paint Traffic White RAL9016
 - BL - Glossy Black Powder Paint Jet Black RAL9005
 - MBL - Matte Black Lava PU19115
 - DU - Black Bronze Anodized - Class 1
 - SA - Satin Anodized - Class 1
 - PT - Custom Powder Paint

AUTOMATION (by others)

- Yes (NOTE:API00S)
- No

LEAD STILE

- Single Handle Lead Stile
 - Double Handle Lead Stile (BTB)
- DOUBLE LEAD STILE IS STANDARD**

SILL TYPE

- Raised Track
 - Flush Track**
- **Trench Drain (By others) recommended for Exterior Application

LOCKING

- 2 Point Surface Catch
- 2 Point Recessed Catch

NOTE: Kynar not available for P100S Model

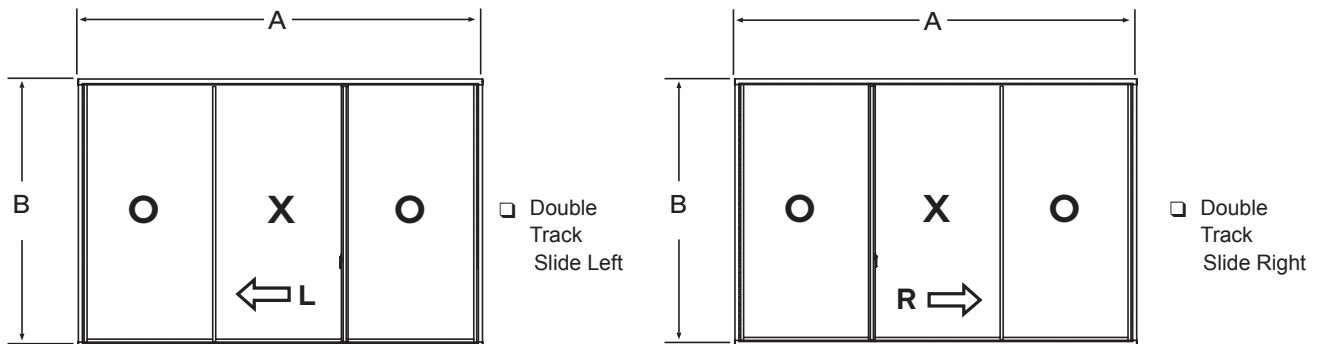
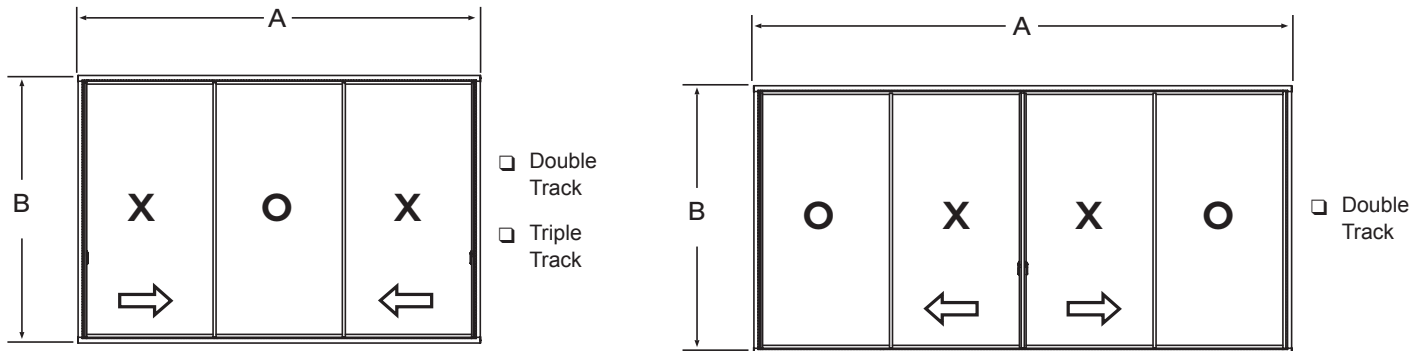
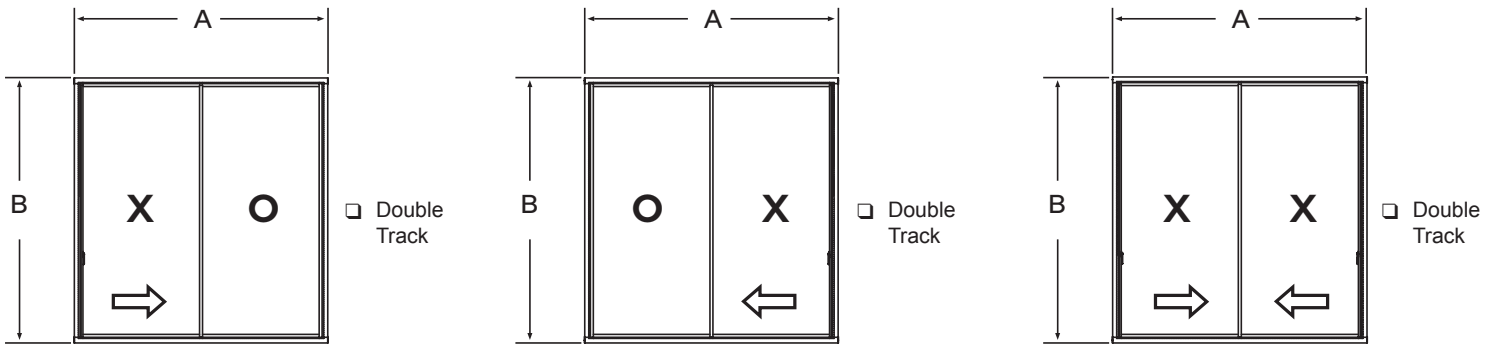

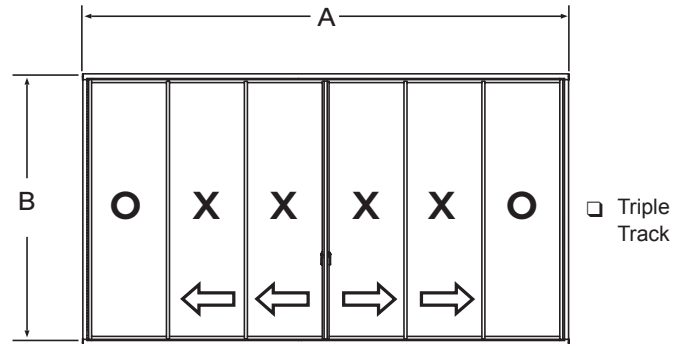
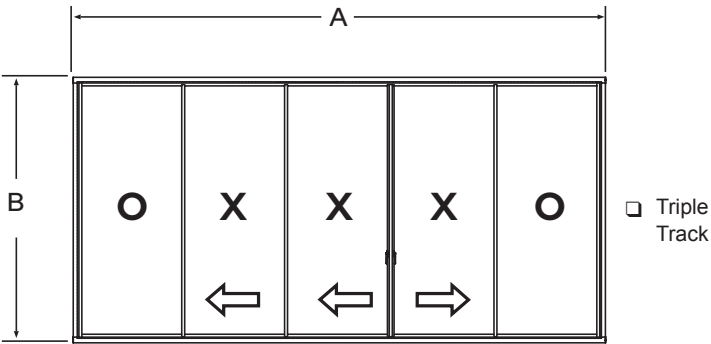
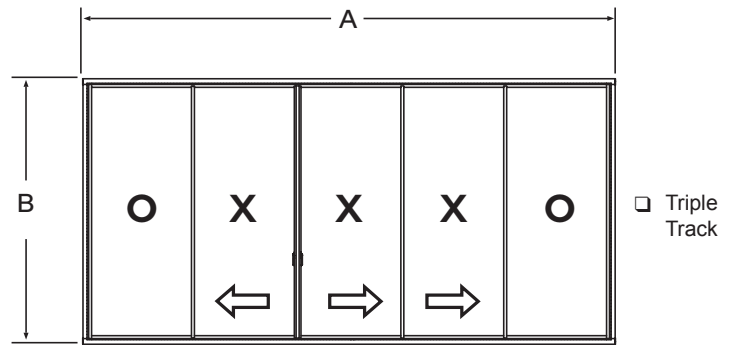
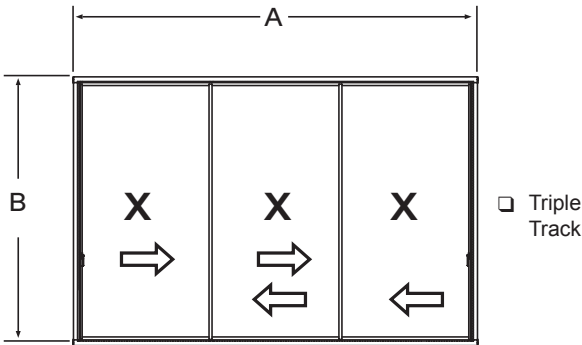
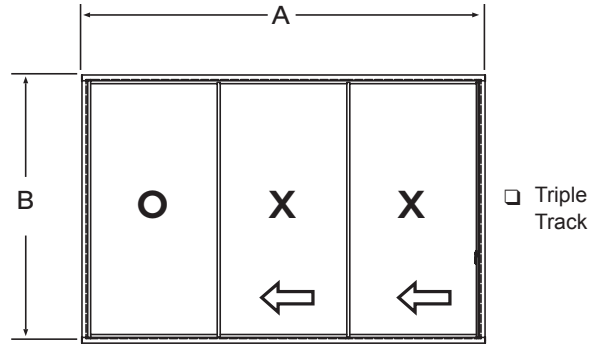
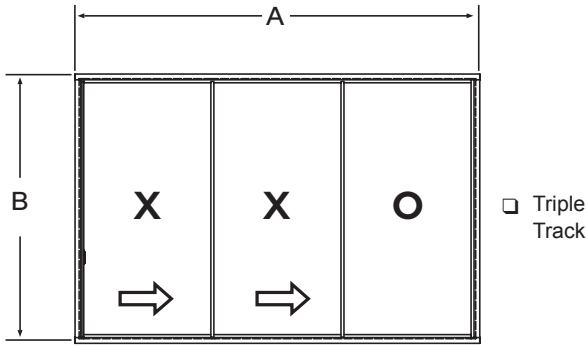

**NOTE: SYSTEM VIEWS ARE FROM
INTERIOR LOOKING OUT**

| MARK | QTY | DIM A (WIDTH) | DIM B (HEIGHT) |
|------|-----|------------------|-------------------|
| | | | |
| | | | |
| | | | |

| FOR OFFICE USE ONLY | |
|---------------------|-------|
| TAKEN BY: | _____ |
| PRICED BY: | _____ |
| EDITED BY: | _____ |

APPROVED BY _____ DATE _____

SECTION DETAILS

NET FRAME WIDTH

LEAD STILE OPTIONS

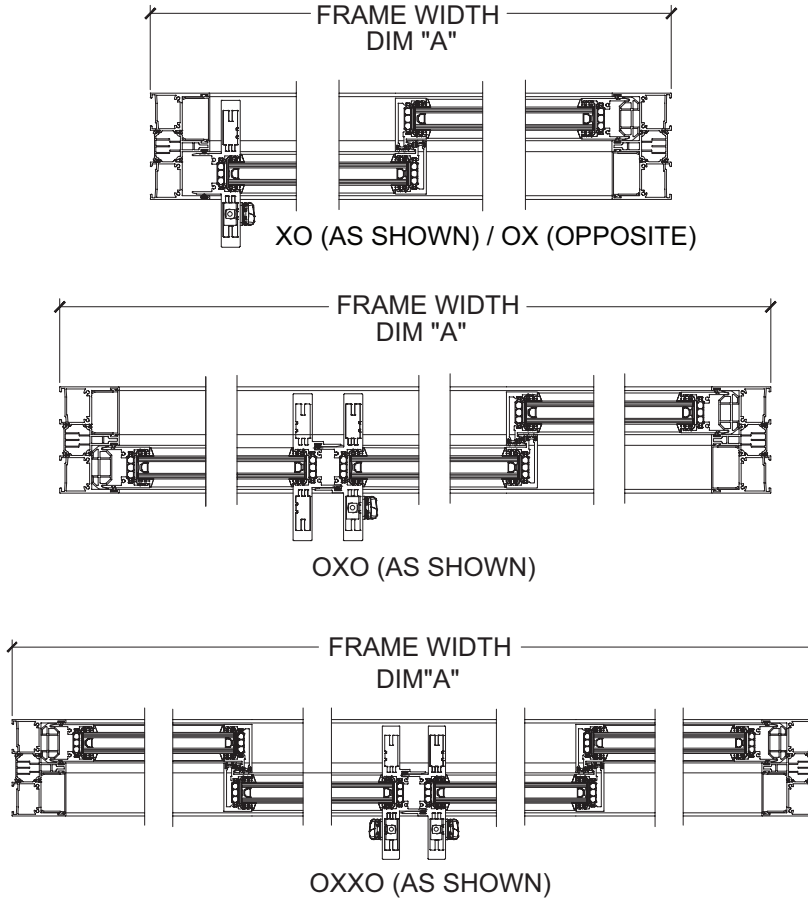
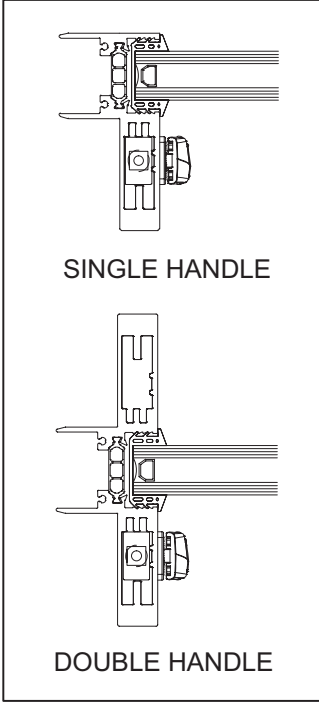

INTERLOCK OPTIONS

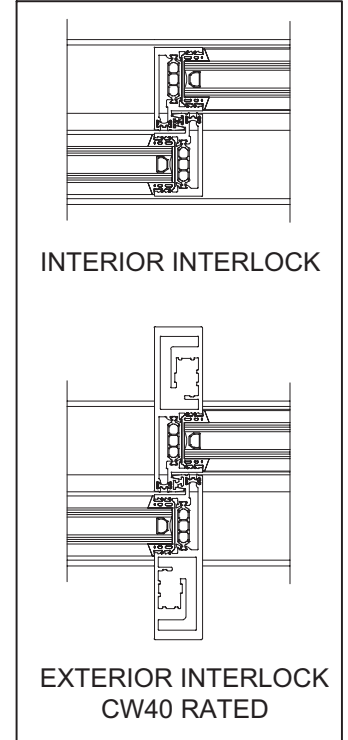

NET FRAME HEIGHT

DOUBLE TRACK

TRIPLE TRACK

