

USE OF GASKETS

FOR 1/4" (6mm) GLASS: USE ONE THICK GASKET ON EACH SIDE

FOR 5/16" (8mm) GLASS: USE ONE THIN GASKET ON EACH SIDE

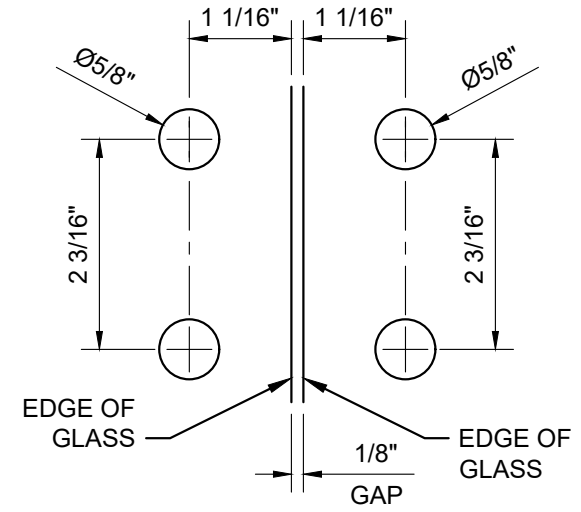
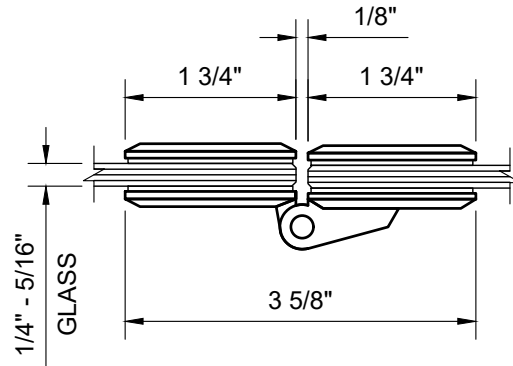

GLASS FABRICATION TEMPLATE

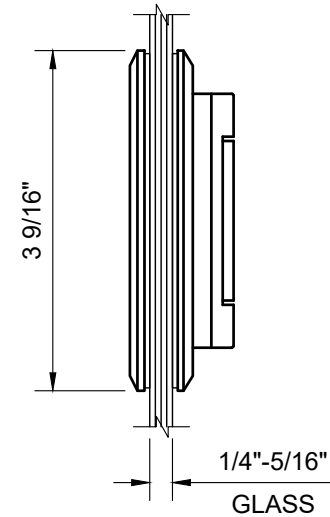
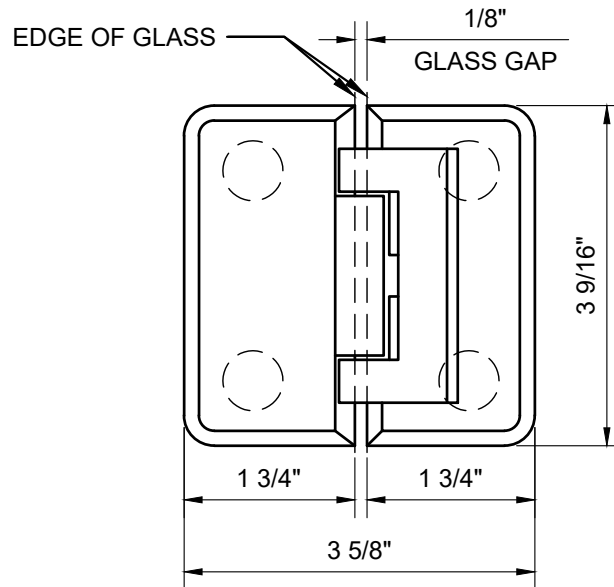

CATALOG NUMBER	FINISH
PET181CH	POLISHED CHROME
PET181BR	POLISHED BRASS
PET181BN	BRUSHED NICKEL
PET181GP	GOLD PLATE
PET181PN	POLISHED NICKEL
PET181SC	SATIN CHROME

PET181XX - CRL PETITE SERIES 180° OUT SWING ONLY GLASS TO GLASS HINGE

DATE: 3/8/19

SCALE: 6"=1'-0"

DRAWN BY: VM

DESCRIPTION: CRL PETITE SERIES HINGE

PET181_180° SWING OUT ONLY
GLASS TO GLASS HINGE

C.R. LAURENCE CO. ARCHITECTURAL PRODUCTS
2503 E. Vernon Avenue, Los Angeles, CA 90058-1897
PH (800)-421-6144 FX: 800-587-7501 www.crlaurence.com

