

PART NUMBER	FINISH	L
BMNW12X12CH	CHROME	12"
BMNW12X12BR	BRASS	12"
BMNW12X120RB	OIL RUBBED BRONZE	12"
BMNW12X12BN	BRUSHED NICKEL	12"
BMNW12X12BSC	BRUSHED SATIN CHROME	12"
BMNW12X12PN	POLISHED NICKEL	12"
BMNW12X12SC	SATIN CHROME	12"
BMNW12X12W	WHITE	12"

BMNW18X18CH	CHROME	18"
BMNW18X18BR	BRASS	18"
BMNW18X180RB	OIL RUBBED BRONZE	18"
BMNW18X18BN	BRUSHED NICKEL	18"
BMNW18X18BSC	BRUSHED SATIN CHROME	18"
BMNW18X18PN	POLISHED NICKEL	18"
BMNW18X18SC	SATIN CHROME	18"
BMNW18X18W	WHITE	18"

BMNW24X24CH	CHROME	24"
BMNW24X24BR	BRASS	24"
BMNW24X240RB	OIL RUBBED BRONZE	24"
BMNW24X24BN	BRUSHED NICKEL	24"
BMNW24X24BSC	BRUSHED SATIN CHROME	24"
BMNW24X24PN	POLISHED NICKEL	24"
BMNW24X24SC	SATIN CHROME	24"
BMNW24X24W	WHITE	24"
BMNW24X24ABN	ANTIQUE BRUSH NICKEL	24"
BMNW24X24BS	BRUSHED STAINLESS	24"
BMNW24X24MBL	MATTE BLACK	24"
BMNW24X24PS	POLISHED STAINLESS	24"
BMNW24X24SB	SATIN BRASS	24"

BMNW30X30CH	CHROME	30"
BMNW30X30BR	BRASS	30"
BMNW30X300RB	OIL RUBBED BRONZE	30"
BMNW30X30BN	BRUSHED NICKEL	30"
BMNW30X30BSC	BRUSHED SATIN CHROME	30"
BMNW30X30PN	POLISHED NICKEL	30"
BMNW30X30SB	SATIN BRASS	30"
BMNW30X30SC	SATIN CHROME	30"
BMNW30X30SN	SATIN NICKEL	30"
BMNW30X30W	WHITE	30"

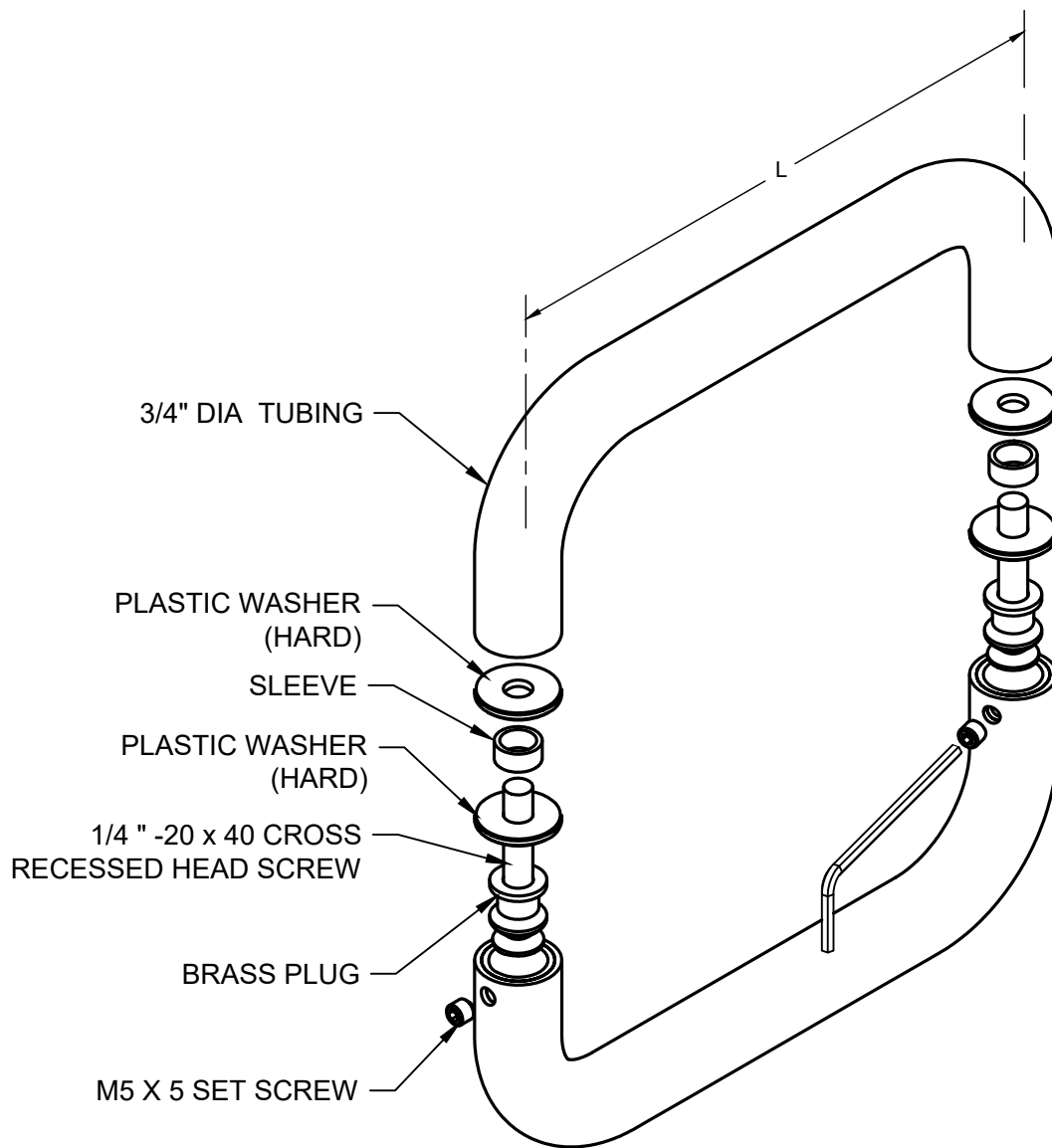

Material: 3/4" dia. Brass Tubing .060" thk.
 1-1/4" dia. metal washers
 Glass Thickness Range: 1/4" to 1/2"
 Hole Diameter Required: 1/2"



C.R. LAURENCE CO.
 ARCHITECTURAL PRODUCTS
 PH (800)-421-6144 FX: 800-587-7501
 www.crlaurence.com

DESCRIPTION:

BMNW BACK TO BACK TOWEL BAR

PART #:	SEE CHART	DATE:	10/30/18
FILE NAME:	BMNW TOWEL BAR	SCALE:	NTS
DRAWN BY:	BRIAN R.		