

Calculating Glass Sizes - Frameless Hinge KD Door Kit for 1/4" (6mm) Glass

Cutting Formula for Frameless Hinge KD Door Kit for 1/4" (6mm) Glass

This information applies to Cat. No.'s HDK64 and HDK72

Components Description

HINGE JAMB ASSEMBLY - 64" (1626mm) or 72" (1829mm) length
STRIKE JAMB ASSEMBLY - 64" (1626mm) or 72" (1829mm) length
BOTTOM DRIP RAIL - 36" (914mm) length
HANDLE WITH MAGNET
HARDWARE PACKAGE THAT INCLUDES APPROPRIATE SCREWS AND ANCHORS

Glass Size Cutting Formula

WIDTH = OVERALL WIDTH LESS 7/8" (22mm)
HEIGHT = JAMB HEIGHT LESS 3/8" (10mm) for bottom clearance

Glass Fabrication Information

Hinge holes are 1" (25mm) in diameter and located:
Top Hinge: 8" (203mm) down from the top, 1-1/4" (32mm) in from the edge of the glass to the center of the 1" (25mm) hole.
Bottom Hinge: 7-5/8" (194mm) up from the bottom, 1-1/4" (32mm) in from the edge of the glass to the center of the 1" (25mm) hole.

Note: Magnetic Handle Slips on and requires no glass fabrication.

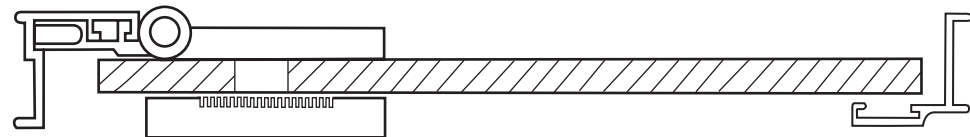
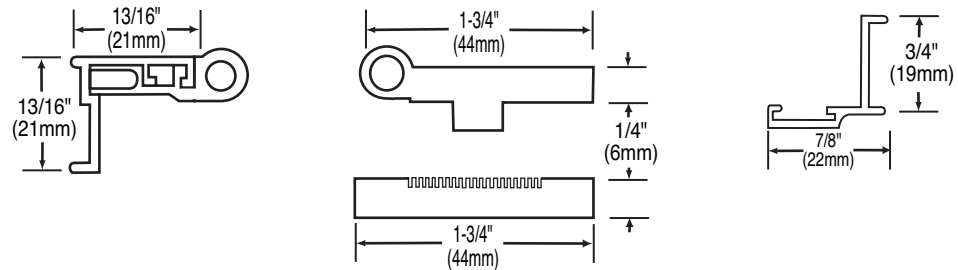

Frameless Hinge KD Door Kit for 1/4" (6mm) Glass

This information applies to Cat. No.'s HDK64 and HDK72

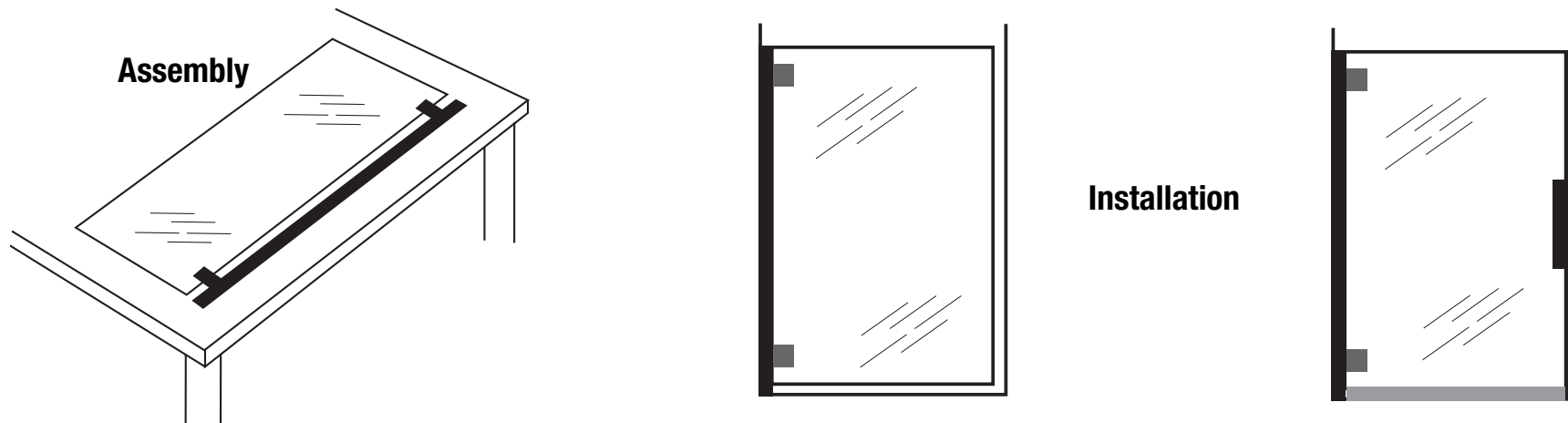

Prior to the actual installation, there are several steps that must be completed.

Assembly Instructions:

1. Attach the jamb with the hinges to the glass. Adjust the hinge in a way that the overall width of the hinge and jamb combination is 3/8" (10mm) less than the door opening width.

Installation Instructions:

1. Stand the door in the opening. Be sure that you have the 3/8" (10mm) clearance at the strike side that was mentioned above.
2. Mark the holes in the hinge side jamb for drilling.
3. After drilling the holes, either use the provided plastic screw anchors (making sure that the substrate that is being screwed into is structurally secure), or screw directly into a stud.
- 4. Caution: Using a short shank screwdriver could damage the glass or screw heads. Use a long shank screwdriver tip (Cat. No. 492A).**
5. Fasten the hinge jamb to the wall.
6. Align the strike jamb to the door and mark the holes in the jamb for drilling. Fasten the strike jamb into place.
7. Cut the drip rail (cutting it at the hinge side) 1/8" (3mm) less than the actual door glass size. Slip the drip rail on the bottom of the door.
8. Align the handle on the strike side of the door to match the strike plate on the jamb.
9. Run a bead of 33S Clear Silicone Sealant inside and out.

3-35B