

CRL ALUMINUM DOOR MOUNTED STANDARD PULL HANDLES

24" GLASS MOUNTED 1-1/4" DIAMETER OFFSET PULL HANDLE



CAT. NO.
CD24X24BS125

INCLUDED MOUNTING HARDWARE

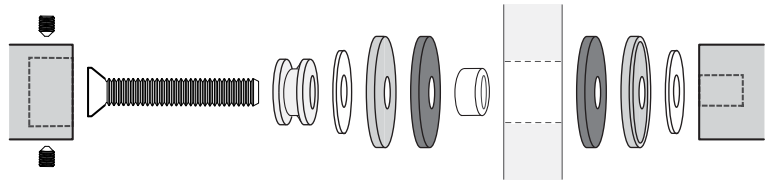

5/16"-18 Back-to-Back
Glass Door Mount Shown

MOUNTING TEMPLATE

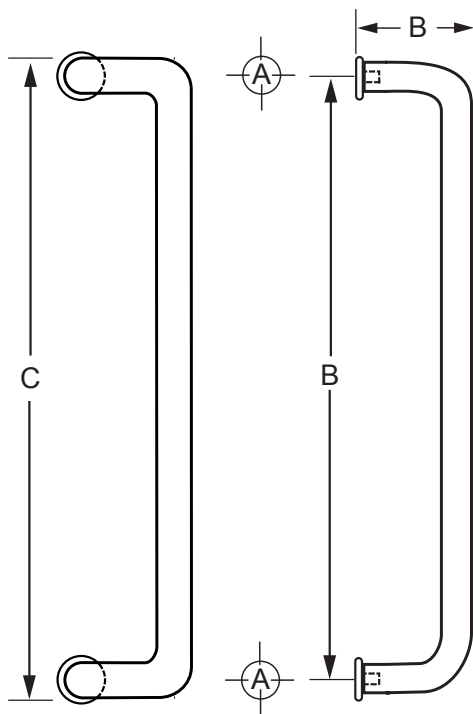

FINISH
BS = BRUSHED STAINLESS

CAT. NO.	B	C	D
CD24X24	24" (610 mm)	25" (635 mm)	3" (76 mm)

Hole Size: A		B	C	D
Glass 5/8" (16 mm)	Wood/Aluminum 5/16" (8 mm)	24" (610 mm)	25" (635 mm)	3" (76 mm)

Mounting Options	Glass 3/8"-3/4" (10 to 19 mm)	Wood/Aluminum up to 1-3/4" (45 mm)
Hole Size: A	5/8" (16 mm)	5/16" (8 mm)
Hardware	Cat. No. F40WK Included	Cat. No. DH004AL For use with CD24X24BS125 only

NOTE: Optional hardware kits must be purchased separately.

