

CRL ALUMINUM DOOR MOUNTED STANDARD PULL HANDLES

GLASS MOUNTED 1" DIAMETER OFFSET PULL HANDLE



CAT. NO.
CD10X10
CD12X12
CD18X18

INCLUDED MOUNTING HARDWARE

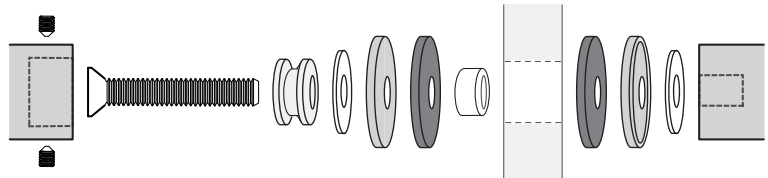

5/16"-18 Back-to-Back
Glass Door Mount Shown

MOUNTING TEMPLATE

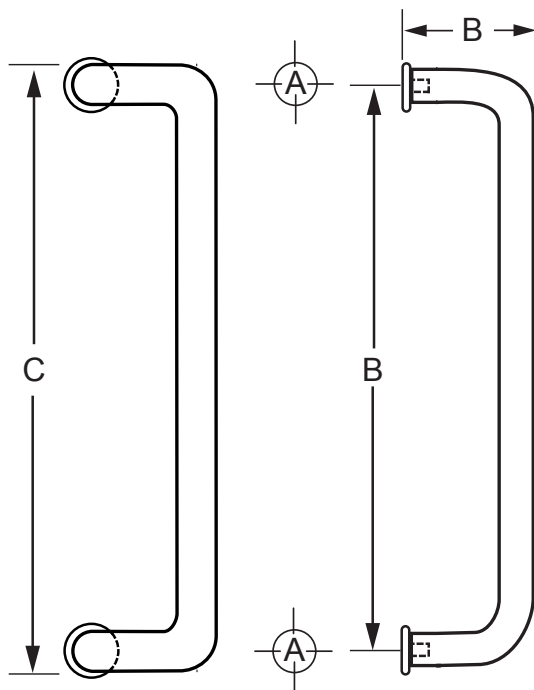

ADD TO CAT. NO. FOR FINISH
BR = POLISHED BRASS
BS = BRUSHED STAINLESS
DU = DARK BRONZE
PS = POLISHED STAINLESS
SA = SATIN ANODIZED

CAT. NO.	B	C	D
CD10X10	10" (254 mm)	11" (279 mm)	3" (76 mm)
CD12X12	12" (305 mm)	13" (330 mm)	3" (76 mm)
CD18X18	18" (357 mm)	19" (483 mm)	3" (76 mm)

Mounting Options	Glass 3/8"-3/4" (10 to 19 mm)	Wood/Aluminum up to 1-3/4" (45 mm)
Hole Size: A	5/8" (16 mm)	5/16" (8 mm)
Hardware	Cat. No. F40WK Included	Cat. No. TB4CH Optional

NOTE: Optional hardware kits must be purchased separately.

