

CRL ALUMINUM DOOR MOUNTED STANDARD PULL HANDLES

CRL EXTRA LENGTH LADDER STYLE BACK-TO-BACK PULL



CAT. NO.

- 24LP
- 30LP
- 36LP
- 42LP
- 48LP
- 54LP
- 60LP
- 66LP
- 72LP
- 78LP
- 84LP

INCLUDED MOUNTING HARDWARE

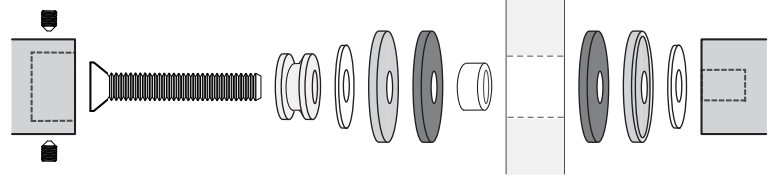

5/16"-18 Back-to-Back
Glass Door Mount Shown

MOUNTING TEMPLATE

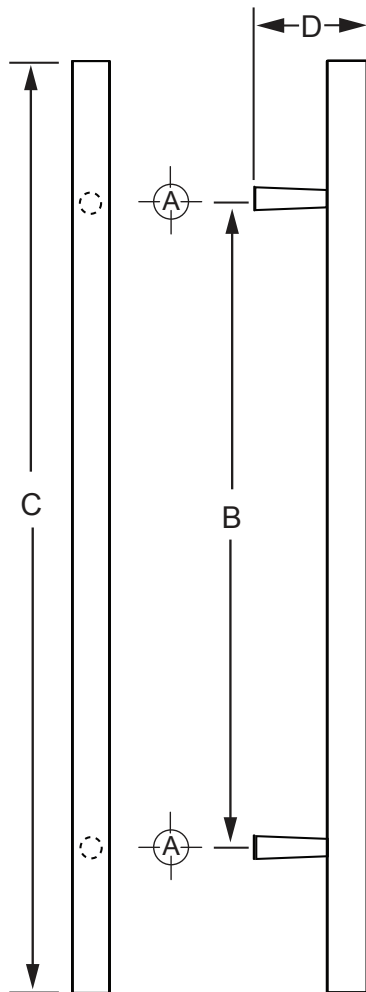

ADD TO CAT. NO. FOR FINISH

BS = BRUSHED STAINLESS

PS = POLISHED STAINLESS

CAT. NO.	Hole Size: A		B	C	D
	Glass	Wood/ Aluminum			
24LP	5/8" (16 mm)	5/16" (8 mm)	12" (305 mm)	24" (610 mm)	3" (76 mm)
30LP	5/8" (16 mm)	5/16" (8 mm)	18" (457 mm)	30" (762 mm)	3" (76 mm)
36LP	5/8" (16 mm)	5/16" (8 mm)	24" (610 mm)	36" (914 mm)	3" (76 mm)
42LP	5/8" (16 mm)	5/16" (8 mm)	30" (762 mm)	42" (1067 mm)	3" (76 mm)
48LP	5/8" (16 mm)	5/16" (8 mm)	36" (914 mm)	48" (1219 mm)	3" (76 mm)
54LP	5/8" (16 mm)	5/16" (8 mm)	42" (1067 mm)	54" (1372 mm)	3" (76 mm)
60LP	5/8" (16 mm)	5/16" (8 mm)	48" (1219 mm)	60" (1524 mm)	3" (76 mm)
66LP	5/8" (16 mm)	5/16" (8 mm)	54" (1372 mm)	66" (1676 mm)	3" (76 mm)
72LP	5/8" (16 mm)	5/16" (8 mm)	60" (1524 mm)	72" (1829 mm)	3" (76 mm)
78LP	5/8" (16 mm)	5/16" (8 mm)	66" (1676 mm)	78" (1981 mm)	3" (76 mm)
84LP	5/8" (16 mm)	5/16" (8 mm)	72" (1829 mm)	84" (2134 mm)	3" (76 mm)

Mounting Options	Glass 3/8"-3/4" (10 to 19 mm)	Wood/Aluminum up to 1-3/4" (45 mm)
Mounting Hardware	Cat. No. F40WK Included	Cat. No. TB4CH

NOTE: Optional hardware kits must be purchased separately.

