



C.R. LAURENCE CO., INC.

COTTAGE SERIES SLIDING SHOWER ENCLOSURE COMPONENTS



Slide Jamb

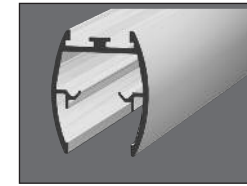

Header

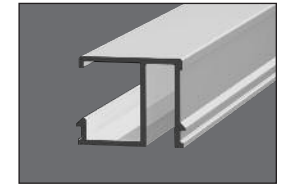

Header Filler

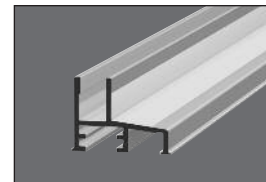

Sidelite Sill



Top Hanger

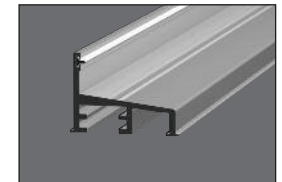

Bottom Sill

C.R. Laurence Company has established a Technical Sales Department to assist our customers. If you have any questions concerning shower door hardware or any product from CRL, please contact us at: (800) 421-6144 in the U.S., or (877) 421-6144 from Canada, and ask for Extension 7740

C.R. LAURENCE CO., INC.

Cutting Formula for Cottage Series Sliding Shower Door Kits

This information applies to DK and CK Series Sliders (Installation instructions are shown in Section 3)

Components Description

HEADER
TOP HANGER
SIDE JAMB
BOTTOM TRACK
CLEAR JAMB (CK Series Only)

Metal Size Cutting Formula

HEADER= TOP WIDTH MEASUREMENT LESS 1/16" (1.5mm)
SIDE JAMB= OVERALL HEIGHT LESS 1-15/16" (49mm)
BOTTOM TRACK FOR DK SERIES= BOTTOM MEASUREMENT LESS 3/4" (19mm)
BOTTOM TRACK FOR CK SERIES= BOTTOM MEASUREMENT LESS 1/16" (1.5mm)

Glass Size Cutting Formula

WIDTH FOR DK SERIES= OVERALL WIDTH DIVIDED BY 2, PLUS 3/8" (10mm)
WIDTH FOR CK SERIES= OVERALL WIDTH DIVIDED BY 2, PLUS 13/16" (21mm)
HEIGHT FOR DK OR CK SERIES= OVERALL HEIGHT LESS 3-1/16" (78mm)

Sliding Panel Top Hanger Fabrication Instructions

Top Hanger for 3/8" (10 mm) glass requires a 1/2" (12 mm) diameter hole, 13/16" (21mm) down from the top edge to the center. The recommended position from the vertical edge of the glass inward is 2-1/2" (64mm)

Top Hanger for 1/4" (6 mm) glass requires a 1/2" (12 mm) diameter hole 13/16" (21 mm) down from the top edge to the center. The recommended position from the vertical edge of the glass inward is 2-1/4" (57 mm) to the center of the diameter.

All Stock 3/8" (10 mm) and 1/4" (6 mm) Frameless

Sliders come with a Knob and a 24" (610 mm) Towel Bar

All Towel Bars and Knobs require 1/2" (12 mm) diameter holes. The placement of the holes for the Towel Bar are to be centered on the glass. The holes for the Towel Bar are to be 24" (610 mm) center-to-center.*

The hole placement for the knob is centered on the vertical edge and should match the distance in from the edge with the Towel Bar glass.

***Call for size of Towel Bar provided with custom units.**

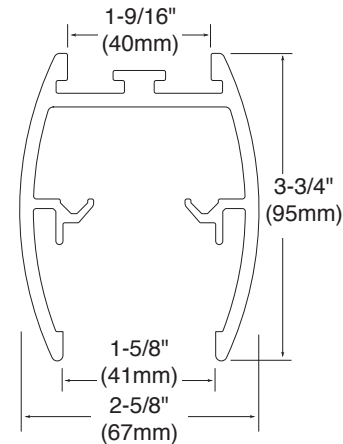

Header for 3/8" (10mm) Glass or 1/4" (6mm) Glass

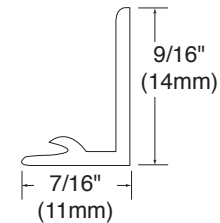

Clear Jamb for 3/8" (10mm) or 1/4" (6mm) Glass

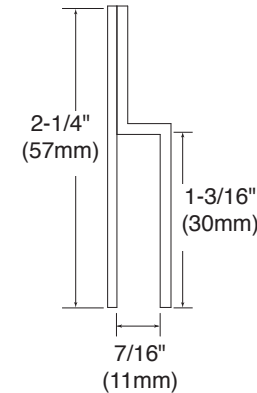

Top Hanger for 3/8" (10mm) Glass

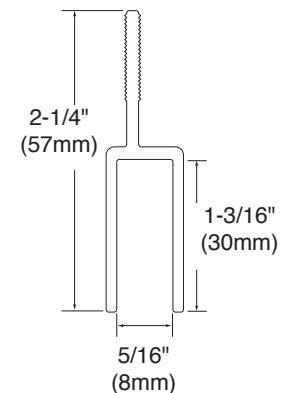

Top Hanger for 1/4" (6mm) Glass

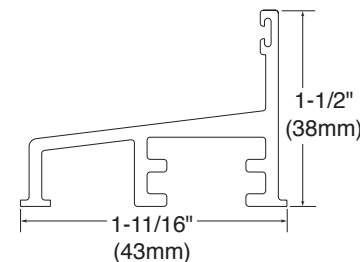

Bottom Track for 3/8" (10mm) or 1/4" (6mm) Glass

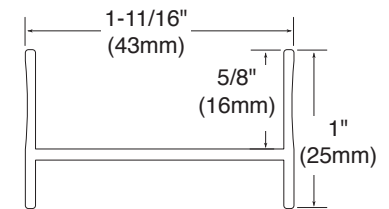

Side Jamb for 3/8" (10mm) or 1/4" (6mm) Glass

This information applies to Cottage-DK and CK Series Sliders

(Fabrication and Glass Sizing Information is shown in Section 2.)

Assembly Instructions for Cottage-DK and CK Sliders:

1. Remove the nylon bushing in the roller bracket and place the bushing in the hole in the glass.
2. Slip the roller bracket over the top edge of the glass, aligning the hole in the bracket with the hole in the glass.
3. Fasten the clamping portion together and tighten the screw down snugly. **Important: There is no need to over-tighten the screw.**

This roller bracket is designed to allow the glass to hang on the nylon bushing. There is no adhesive necessary for roller installation.

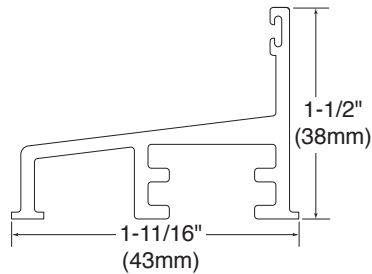

**Bottom Track for 3/8"
(10mm) or 1/4" (6mm) Glass**

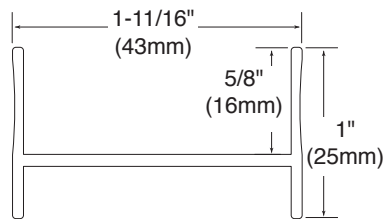

**Side Jamb for 3/8" (10mm)
or 1/4" (6mm) Glass**

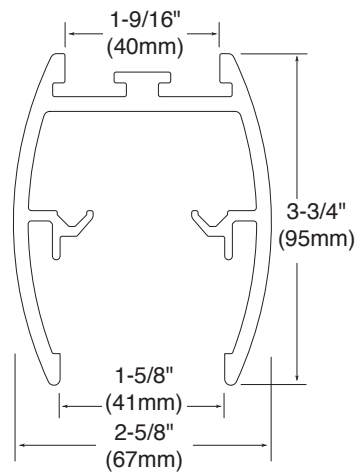

**Header for 3/8" (10mm)
Glass or 1/4" (6mm) Glass**

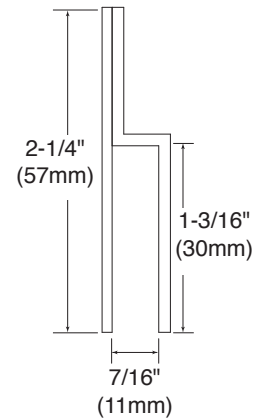

**Top Hanger for 3/8"
(10mm) Glass**

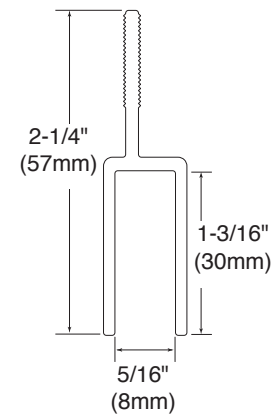

**Top Hanger for 1/4"
(6mm) Glass**

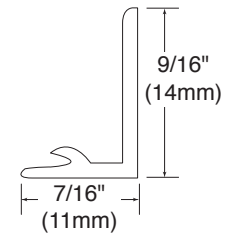

**Clear Jamb for 3/8" (10mm)
or 1/4" (6mm) Glass**

Installation Instructions for Cottage-DK Series Sliders:

1. Place the Bottom Track in the desired position on the tub/curb. Use a level to plumb your Side Jambs. Mark the holes for drilling.
2. Drill the holes into the vertical walls. Use the appropriate anchors to prepare for fastening the Side Jambs.
3. Run a bead of Clear Silicone to the underside of the Bottom Track. Immediately put the track into position.
4. Fasten the Side Jambs into the vertical walls using the screws provided. Be sure to clean up any excess silicone at this time.
5. Install the Header and fasten it to the Side Jambs it on the inside.
6. Hang the panels (the inside panel is hung first). Make the necessary adjustments to accommodate for out-of-level/plumb conditions.
7. Attach the single-sided knob to the inside panel and the single-sided towel bar to the outside panel.
8. Run a bead of Clear Silicone inside and out, along the Side Jambs and Bottom Track, at the walls and curb.
Also, run a bead of Clear Silicone at each end of the Bottom Track where it meets the Jambs.
9. Allow 24 hours for the silicone to cure prior to using the enclosure.

Installation Instructions for Cottage-CK Series Sliders:

1. Put the BWB2 Wall-mounting Bracket into the ends of the cut-to-size Header and tighten locking screws.
2. Place the Bottom Track into the desired position on the curb/tub.
3. Position the Header directly above the Bottom Track assuring the lines from the outside of the Bottom Track are plumb with the opening at the bottom of the Header.
4. Position the Header to the correct height and mark the vertical walls where the BWB2 Brackets will fasten the header to the wall.
5. It is important to make sure the two holes that are drilled to mount the Header to the wall are level to one another. If the holes are drilled incorrectly, the result will be a Header that is crooked on the wall.
6. Permanently fasten the Header to the walls.
7. Run a bead of silicone to the underside of the Bottom Track.
8. Hang the panels (the inside panel is hung first). Make the necessary adjustments to accommodate for out-of-plumb conditions.
9. Attach the single-sided knob to the inside panel and single-sided towel bar to the outside panel.
10. Carefully slide the doors to their closed position assuring the glass doesn't run into the vertical walls.
11. Position the center guide properly and mount it to the Bottom Track.
12. To align the Clear Jambs on the vertical walls use the following method: Cut the Pre-taped Clear "L" Jam to size and close the door within 1/4" (6mm) of the vertical wall. Place the "L" shape of the Clear Jamb on the end of the sliding door, keeping the portion that is to be taped to the wall about 1/8" (3mm) away from the wall. Pull approximately 10" (254mm) of the release liner of the tape down and away from the Clear Jamb. Using the glass as a guide, slowly push the Clear Jamb onto the wall. Pull small amounts of release liner and continue to the bottom using the glass as a guide to assure a consistent line, then continue to remove the liner.
13. Run a bead of silicone where the Bottom Track rests on the curb/tub on the inside and outside.
14. Allow 24 hours for the silicone to cure prior to using the enclosure.