

CRL Tube Style Standoff Installation Instructions

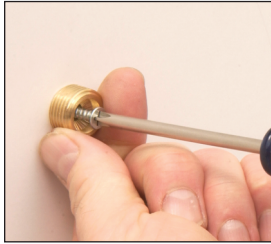

Set Threaded Insert to Wall



Place Base onto Threaded Insert and Fasten



Tighten Base with
Cat. No. ASW12
Adjustable Strap Wrench



Align Hole in Panel and
Install Cap Assembly

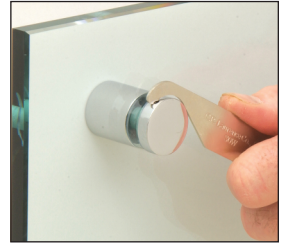

Tighten Cap with
Cat. No. SOW Wrench

Installation Options and Accessories

Note: Mounting and Installation Accessories ordered separately

Due to the diversity of applications, weight limitations for Standoff Systems are dependent upon wall or substrate anchoring and material strengths.

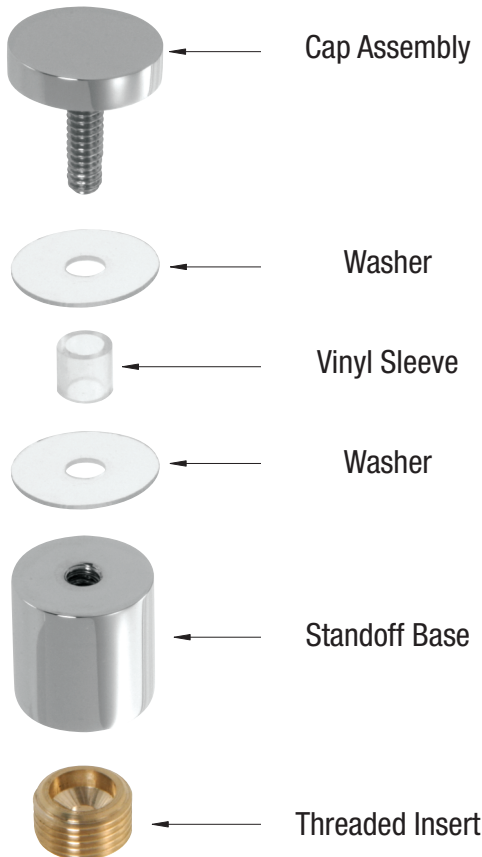

CAT. NO. HR12X112
Plastic Anchor
For use in concrete, brick or stone



CAT. NO. T11011
TOGGLER® Anchor
For attaching Standoffs into drywall, panels, plaster walls or hollow core doors



CAT. NO. 8X2FHPSMS
Phillips Screw
For installation of Threaded Insert into Anchor or wood blocking



CAT. NO. 70231
Toggle Bolt
Used for installations into wallboard, wood or steel up to 2-1/2" (63.5 mm) thick



CAT. NO. ASW12
Adjustable Strap Wrench
For tightening or loosening Standoff Bases



CAT. NO. SOW
Standoff Wrench
For tightening or loosening Standoff Caps

TOGGLER is a registered trademark of Mechanical Plastics Corp.