

CRL ALUMINUM DOOR MOUNTED STANDARD PULL HANDLES

CRL 1" X 10" SOLID OFFSET PULL HANDLE



CAT. NO.
2952A
2952BRZ

INCLUDED MOUNTING HARDWARE

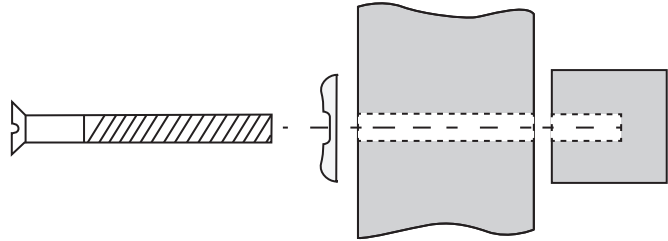

1/4"-20 Thru Bolts
with Finish Washers

MOUNTING TEMPLATE

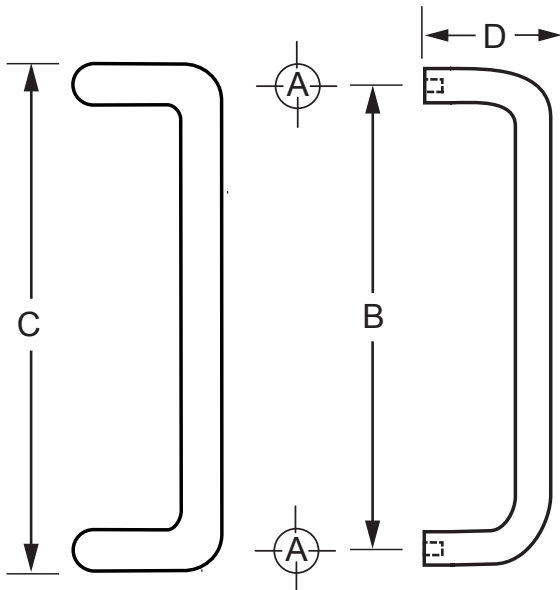

FINISH
2952A = ANODIZED SATIN
2952BRZ = DARK BRONZE

NOTE: Select appropriate Cat. No. for color and finish.

Hole Size: A	B	C	D
Wood/Aluminum 1/4" (6 mm)	10" (254 mm)	11" (279 mm)	3-1/4" (83 mm)

Mounting Options	Wood/Aluminum up to 1-3/4" (45 mm)
Mounting Hardware	Included

NOTE: Optional hardware kits must be purchased separately.

